

Expanding the Possibilities

October 10-12, 2001

Crowne Plaza Hotel
Springfield, Illinois

Conference Guide

Coordinated by: Illinois Subdivision of
the Division for Early Childhood of the
Council for Exceptional Children (IDEC)

Sponsored by:

ILLINOIS STATE BOARD OF EDUCATION

StarNet

Project CHOICES

Division of Early Childhood Education

ILLINOIS DEPARTMENT OF HUMAN SERVICES

Bureau of Part C Early Intervention

Illinois Network of Child Care Resource
and Referral Agencies

Illinois Early Childhood Intervention Clearinghouse

ILLINOIS DEPARTMENT OF CHILDREN AND FAMILY SERVICES

GREAT LAKES HEAD START QUALITY IMPROVEMENT

CENTER FOR DISABILITIES

**ILLINOIS ASSOCIATION FOR THE EDUCATION
OF YOUNG CHILDREN**

**ILLINOIS SUBDIVISION OF THE DIVISION FOR EARLY CHILDHOOD
OF THE COUNCIL FOR EXCEPTIONAL CHILDREN**

AMERICORPS BENEFITS CHILDREN (ABC) LITERACY PROGRAM



The 7th Illinois Statewide Collaborative Early Childhood Conference

Faculty Enrichment

“The Changing Nature of Teacher Education in Illinois”

Early Childhood Faculty, Inservice Trainers, and other interested individuals are invited to join their colleagues in Plaza A for exciting Faculty Enrichment opportunities during both days of the Sharing a Vision Conference. The following sessions are those that may be of particular interest.

Thursday, October 11, 2001 • Plaza A

7:30 am – 9:00 am • Continental Breakfast and Table Talk

Enjoy breakfast and discussion of student portfolios, led by Dr. Jean Wolf, WIU.

10:15 am – 12:00 pm

“Shift Happens: Resources for Infusing New Content and Capabilities in Teaching/Training Practices”

Presented by Camille Catlett, M.A., Frank Porter Graham Child Development Center, University of North Carolina.

This session will provide participants with methods and materials for supporting changes in practice suggested by the new DEC Recommended Practices. High-quality, low-cost resources for teaching, training, and staff development will be shared. Emphasis will be placed on family-practitioner collaboration, serving culturally and linguistically diverse children and families, and service delivery in diverse community settings.

12:00 pm – 1:15 pm • Lunch Break and Table Talk

Pick up your box lunch and join other early childhood faculty for discussion and sharing of ideas. Discussion will focus on what a teacher educator in Illinois needs to “know” and be able to “do” to prepare teachers of the future. Facilitated by Dr. Jean Wolf, WIU.

1:30 pm – 3:00 pm • Choose from over 18 workshops!

3:15 pm – 4:45 pm • Afternoon Break

Visit with colleagues, exchange resources and enjoy munchies while Camille Catlett shares a variety of early childhood resources. You will receive a copy of the *10th Edition of the Resource Guide: Selected Early Childhood/Early Intervention Training Material* by Catlett and Winton.

Friday, October 12, 2001 • Plaza A

7:30 am – 9:00 am • Continental Breakfast and Table Talks

Enjoy breakfast and a discussion of faculty research ideas and current research projects. Facilitated by Dr. Amy Santos, UIUC

9:00 am – 10:30 am • Join other attendees for the general session.

Hear Dr. Judy Harris-Helm present “Contegrity — Why We Do What We Do, The Way We Do It, and How We Know We Did It.”

10:45 am – 12:15 pm • Choose from over 18 workshops!

12:15 pm — 1:30 pm • Lunch Break

Pick up your box lunch and enjoy a motivational discussion led by Dr. Susie Nall, Professor and Director of Early Childhood Education, Southern Illinois University-Edwardsville

1:30 pm – 3:00 pm • Choose from over 18 workshops!



Sharing A Vision: Expanding the Possibilities

October 10, 2001

Dear Conference Participant,

We want to take this opportunity to welcome each of you to the 7th Illinois Statewide Collaborative Early Childhood Conference, Sharing A Vision: Expanding the Possibilities. Once again the Sharing A Vision Committee has worked very hard for the past 13 months to plan an educational and enriching conference for the early childhood practitioners and families of our state. We planned a conference filled with sessions and activities that we hope will expand the possibilities of growth and learning for you and Illinois' young children and families.

When you browse through your conference guide, you will find a variety of sessions and networking opportunities. We have invited nationally and locally recognized speakers to share their expertise on various early childhood topics during our Plenary and regular conference sessions. In addition, join us at the Showcasing sessions where various programs have been invited to share their ideas, resources, and information. We have also expanded the Faculty Enrichment Strand to include table-talk discussions for faculty and inservice trainers. Finally, don't forget to visit the Exhibit Hall while you're at the conference. It's a great place to shop, win prizes, relax and unwind with friends.

For our 'seasoned' Sharing A Vision conference attendees, nothing pleases us more than to be able to say, "Welcome Back!" We read your comments from the 1999 conference and noted what you liked and what you would change for this year's conference. We hope that you will be pleased with the changes we have made.

Your feedback is very important to us. We strongly encourage you to take time to complete the evaluation forms included in your packet and return them to the evaluation table before you leave the conference. Your feedback will assist the committee members in planning the 2003 Sharing A Vision Conference.

One final note, we are very excited to announce that the Illinois State Board of Education – State Teacher Certification Board has approved Sharing A Vision to be a Professional Development Provider. This means that your participation in this year's conference can count towards your teacher certificate renewal. Stop by the Continuing Education booth for more information.

On behalf of the 2001 Sharing A Vision Planning Committee, we hope that you enjoy the conference and find this a special time for professional and personal renewal.

Sincerely,

Amy Santos and Bernie Laumann
Sharing A Vision Co-chairs



Illinois State Board of Education

100 North First Street • Springfield, Illinois 62777-0001

Ronald J. Gidwitz
Chairman

www.isbe.state.il.us

Glenn W. McGee
State Superintendent of Education

October 2001

Dear Conference Participants:

Welcome to "Sharing A Vision!" The importance of providing early childhood education opportunities has never been more vital.

Learning should not have an age limit. I do not believe that any child is too young to learn or that any adult is too old to acquire new knowledge. Learning is indeed a lifelong process. Starting children on the path to learning **must** begin at an early age. By giving young children a jumpstart on their education, we are ensuring their futures.

I particularly like the "sharing" portion of the title of this year's conference. Working together, sharing ideas and techniques, developing strategies and policies, and exchanging information will help us give Illinois students an education that is indeed *Second to None*.

I hope you enjoy the conference. The knowledge you gather here can be taken back to your districts, communities, and schools, and *shared* with everyone involved in education. Together we can give our earliest learners every opportunity they need to succeed.

Sincerely,

Glenn W. McGee
State Superintendent
of Education

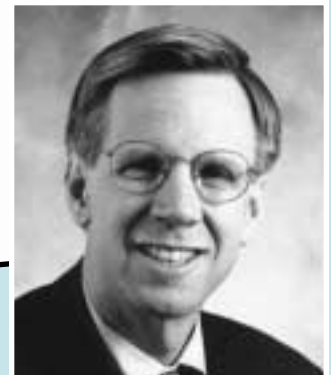

George H. Ryan, Governor



100 South Grand Avenue, East • Springfield, Illinois 62762
401 South Clinton Street • Chicago, Illinois 60607

Linda Renee Baker, Secretary

Dear Conference Participants:

Welcome to the **2001 Sharing a Vision Conference**. I am pleased that, once again, the Illinois Department of Human Services is involved in offering you this excellent networking and learning opportunity. The conference theme, **Expanding the Possibilities**, challenges all of us to work together and maximize efforts and resources directed to young children and their families.

The **2001 Sharing A Vision Conference** offers important strategies and tools for early intervention specialists and providers in their work with young children with developmental challenges and their families. I am pleased that families are an important part of this conference. Families motivate us to strive for excellence and educate us on their key role in setting and achieving goals for their children.

Thank you for your commitment to the collaboration of early childhood services in Illinois. I hope you enjoy the conference.

Sincerely,

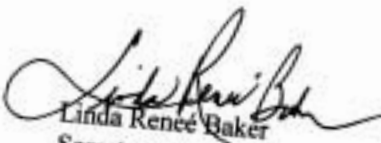
Linda Renee Baker
Secretary

George H. Ryan
Governor

Jess McDonald
Director



Illinois Department of Children & Family Services



Dear Attendee:

Welcome to one of the nation's largest and most important conferences dedicated to early childhood issues. I am proud that leaders from so many professions throughout Illinois have joined together to make the Seventh Illinois State Collaborative Early Childhood Conference possible. Professionals like yourself have volunteered thousands of hours to plan workshops, invite speakers and create an open atmosphere of networking. As Director of the state's child welfare agency, I am especially happy that the Illinois Department of Children and Family Services is a co-sponsor of this biennial conference. It is one of those all too rare inclusive events that brings educators, therapists, early intervention specialists, social workers and families together under one roof to share their experiences and insights. This conference promises to be among the most significant events you will attend during your career.

At its core, the Illinois State Collaborative Early Childhood Conference is a true collaborative experience, bringing together people from many walks of life. This conference excels at focusing attention to today's "hot topic" issues. From technology in the classroom to the Reggio education process, from new assessment tools to our state's recently released Early Learning Standards, the wide selection of workshops and table talks offers unparalleled opportunities to learn and exchange ideas. The conference also touches on common concerns that affect us all: building interagency relationships, implementing best practices, choosing the right blends of assessments and services needed to make the best use of the time we spend with children entrusted to our care. In short, this is a place where you can both hone professional skills and build relationships with people who share your commitment to children.

I hope you will feel professionally and personally enriched by attending this special conference. I also hope you will gain a stronger sense of the close ties we mutually share as a community of professionals dedicated to a common cause.

Sincerely,

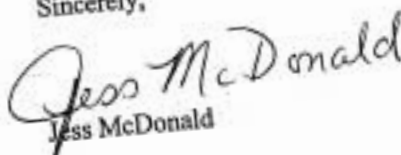

Jess McDonald

Office of the Director
406 E. Monroe Street • Springfield, Illinois 62701
217-785-2509 • 217-524-3715 / TTY

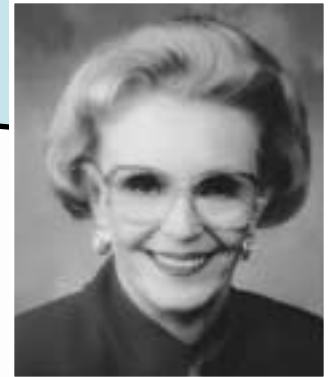

Lura Lynn Ryan
First Lady of Illinois
Chair, Futures for Kids

Robert Kieckhefer
Blue Cross Blue Shield of Illinois
Vice-Chair, Futures for Kids



October 10, 2001

Greetings:

As First Lady of Illinois it is my pleasure to welcome you to the 2001 Sharing a Vision conference.

As the conference theme states, we all share a vision for the children of Illinois- that they all grow up to have bright futures. Futures that are rooted in their early education experiences, whether those experiences are in early intervention programs, childcare, pre-school or Head Start.

Through Futures for Kids we are working to create even more opportunities for young children. As part of Futures we have added the Quality Counts vans to the local Child Care Resource and Referral agencies, created the Great START and TEACH programs as well as developed reading kits for pre-school programs.

With the creation of the Governor's Task Force on Universal Access to Pre-school we are furthering our commitment to young children and their families. The Task Force will help us create a five year plan that will allow all 3 and 4 year olds the opportunity to benefit from quality early education programs.

I would like to invite you to provide your valuable input into the Task Force's work by visiting the Futures for Kids web page at www.futuresforkids.org. Together, we can make a difference in the lives of all of our children.

My continued best wishes for a wonderful conference.

Sincerely,

Lura Lynn Ryan
First Lady of Illinois

Office of the First Lady
100 W. Randolph Street, Floor 16
Chicago, Illinois 60601
(312) 814-2121

Conference Schedule at a Glance

WEDNESDAY, OCTOBER 10, 2001

4:00 pm-7:00 pm	Registration	Plaza Level 1
4:00 pm-7:00 pm	Exhibits	Plaza GHJ-Plaza Level 1
5:00 pm-7:00 pm	Reception	Exhibit Hall
7:00 pm-8:30 pm	Opening Ceremonies — Keynote Address by Dr. Raymond J. Golarz	Ballroom Level 2

THURSDAY, OCTOBER 11, 2001

7:30 am – 4:45 pm	Registration	Plaza Level 1
7:30 am – 9:00 am	Continental Breakfast	Plaza Level and Ballroom Level
7:30 am – 4:30 pm	Exhibits	Plaza GHJ-Plaza Level 1
7:30 am – 4:30 pm	Family Hospitality	Springfield Room Level 3
8:00 am – 10:00 am	Session I Workshop Sessions	See Pages 11-12
8:30 am – 11:30 am	Showcasing I	Prefunction Area-Ballroom Level 2 (See page 9)
10:15 am – 12:00 pm	Session II Workshop Sessions	See Pages 12-14
12:00 pm – 1:15 pm	Lunch	Plaza Level 1 and Ballroom Level 2
12:00 pm – 1:15 pm	IDEC Networking Lunch	Plaza A, Level I
1:30 pm – 3:00 pm	Session III Workshop Sessions	See Pages 14-20
1:00 pm – 4:00 pm	Showcasing II	Prefunction Area-Ballroom Level 2 (See page 9)
3:15 pm – 4:45 pm	Session IV Workshop Sessions and Table Talks	See Pages 20-21
7:00 pm – 9:00 pm	Evening Presentation with Denis Berkson followed by Dessert Reception	Ballroom Level 22
9:30 pm – 11:00 pm	Late Night Entertainment with Elvis	Ballroom Level 2

FRIDAY, OCTOBER 12, 2001

7:30 am – 11:00 am	Registration	Plaza Level 1
7:30 am – 9:00 am	Continental Breakfast	Plaza Level and Ballroom Level
7:30 am – 1:30 pm	Exhibits	Plaza GHJ-Plaza Level 1
7:30 am – 3:00 pm	Family Hospitality	Springfield Room Level 3
8:00 am – 8:50 am	Table Talks	See Page 10
8:30 am – 11:30 am	Showcasing III	Prefunction Area-Ballroom Level 2 (See page 9)
9:00 am – 10:30 am	General Session featuring Dr. Judy Helm	Ballroom Level 2
10:45 am – 12:15 pm	Session I Workshop Sessions	See Pages 21-23
12:15 pm – 1:15 pm	Lunch	Plaza Level 1 and Ballroom Level 2
1:30 pm – 3:00 pm	Session II Workshop Sessions	See Pages 23-25

Thank You!

We would like to recognize those agencies and groups who provided leadership, hard work, and financial support to make the 2001 conference a reality. The Sharing a Vision Conference is coordinated by the Illinois Subdivision of the Division for Early Childhood of the Council for Exceptional Children (IDEC) and sponsored by:

Illinois State Board of Education

StarNet
Project CHOICES
Division of Early Childhood Education

Illinois Department of Human Services

Bureau of Part C Early Intervention
Illinois Network of Child Care Resource and Referral Agencies
Illinois Early Childhood Intervention Clearinghouse

Illinois Department of Children and Family Services

Great Lakes Head Start Quality Improvement Center for Disabilities
Illinois Association for the Education of Young Children
AmeriCorps Benefits Children (ABC) Literacy Program
Illinois Subdivision of the Division for Early Childhood of the Council for Exceptional Children

PLEASE JOIN US FOR LUNCH AND CONVERSATION ABOUT CHANGES IN THE CERTIFICATION PROCESS FOR EARLY CHILDHOOD EDUCATORS AND EARLY CHILDHOOD SPECIAL EDUCATORS

The Illinois Division for Early Childhood (IDEC) invites IDEC members and other interested individuals to bring their lunch and join us for our annual meeting

This meeting we will focus on the new early childhood special education certificate covering birth to eight years of age and changes in the early childhood special education approval covering three to five years of age. As a group we will discuss the implications of these two new training options, the standards and requirements that are related to these options, and how they might be offered at university and college training programs.

The IDEC luncheon and meeting will be held Thursday, October 12 from 12:00 – 1:15 p.m. in Plaza A.

Welcome Families

Once again, Sharing A Vision welcomes families and invites you to join others in the Family Hospitality Room located in the Springfield Room on the 3rd Floor of the Crowne Plaza. The SAV Committee recognizes the important role families serve as part of the educational team for young children. Families will have an opportunity to attend sessions on every aspect of early education, with many focused on the family perspective. Many speakers have volunteered their time to stop by the Family Hospitality Room to discuss issues/concerns or just talk with parents. Breakfast and snacks will be served throughout the day. Families may also win door prizes! Please plan to join us so we can learn together. Listed below are some of the activities:

WEDNESDAY: ***Let's get acquainted*** — Stop in before or after the Keynote and visit with other families. Enter your name for a chance to win a free dinner at the Crowne Plaza. The room will open at 4:00 p.m.

THURSDAY: ***An early start*** — Continental Breakfast will be provided in the Family Hospitality Room from 7:30 a.m. until 9:00 a.m. Sign up if you want to join other parents for dinner.
Let's do lunch! — Bring your box lunch to the Family Hospitality Room. It's another chance to put your name in for a drawing.

Invited Speakers:

10:30 – 11:00 am – Kathy Barclay

12:30 – 1:00 pm – Camille Catlett

3:15 – 3:45 pm – Roseann Slaght and
Catherine Jorgenson

5:00 – 5:30 pm – Phil Gattone

We will also draw door prizes.

Dinner Time — Join other families for dinner. We will meet in the Family Hospitality Room at 5:30 p.m. to decide where to eat dinner. Then we will return in time to hear Denis Berkson, the Creative Crusader, and enjoy late night dessert. Then off to hear Elvis himself!



FRIDAY: ***Last Day*** — Stop by for Continental Breakfast and share your thoughts about the conference, 7:30 a.m. until 9:00 a.m.

Invited Speakers:

1:00 – 1:30 pm – Denis Berkson

***Farewell, have a safe trip home
See you in 2003!***

SNACKS • DOOR PRIZES • COFFEE • CONVERSATION

Kathy Ellinor and Sharon Gage, Family Hospitality Committee



Special Events

Wednesday • October 10

Opening Ceremonies and Keynote

5:00 pm – 7:00 pm **Reception** — Join fellow conference attendees for conversation and hors d'oeuvres in the Exhibit Hall before the Opening Ceremonies.

7:00 pm – 8:30 pm **Ballroom**

Introductions: Dr. Amy Santos and Bernie Laumann, Conference Co-Chairs

Opening Remarks: Bernie Laumann, President, Illinois Subdivision of the Division for Early Childhood of the Council for Exceptional Children

Welcome and Introduction of Dignitaries: Kay Henderson, Division Administrators, Division of Early Childhood Education, Illinois State Board of Education, and Dr. Mary Jayne Broncato, Associate State Superintendent, Illinois State Board of Education

Jeanette McCollum Service to the Field Award: Dr. Susan Maude

Special Invited Guest: Lura Lynn Ryan, First Lady of Illinois



KEYNOTE ADDRESS:

Raymond J. Golarz, Ph.D.

I'll Never Look At You As "Less Than" So That You Can Forever See the "More Than" of Yourself

For almost twenty years, Dr. Raymond J. Golarz has directed work with at-risk children and delinquent gang members near Chicago

and worked extensively with juvenile courts, probation offices and police departments. For approximately five years he taught law enforcement officers in and around Chicago regarding the psychology of delinquency and deviant behavior. During his career he has served as an elementary and secondary school teacher, administrator at various levels including superintendent, and teacher at Indiana University, Purdue University and City University in Seattle. He is co-author of Restructuring Schools for Excellence through Teacher Empowerment and The Power of Participation. In addition, he is the author of Transformational Leadership in the Learning Organization. Dr. Golarz is noted for his humor, inspiration and insights.

Dr. Golarz is highly recommended by early childhood educators. His keynote and breakout session will be of interest to educators and families focusing upon the belief system of adults and society and the impact those beliefs have upon children throughout their lives. If children are to be successful, they and we must believe that they can be successful.

Thursday • October 11

Special Program and Dessert Reception

7:00 pm – 9:00 pm **Ballroom**



Creative Jolts 101 — Making Do or Breaking Through . . . Promoting Your Creative Possibilities

Denis Berkson, WORDPlay & Associates

In this program, Denis Berkson, aka, the "Creative Crusader," explores the key creative elements necessary to help all people be creative personally and professionally.

Topics include:

- *What is creativity?*

- *Myths and truths about the creative process.*
- *How to identify blocks to being more creative.*
- *Understanding the key elements necessary to increase creative thinking.*
- *Simple creative jump starts.*
- *How groups foster creative spirit.*
- *Techniques to enhance risk taking and trust building in the creative process.*
- *Mastering skills of creative goal setting.*
- *Valuable tools for idea generating.*
- *Stories, myths and legends designed to put a new perspective on the creative verb "to create."*

The program utilizes music, humor, interaction and spontaneous insights designed to engage, enlighten and educate the audience.

Denis Berkson has been a professor for over 30 years. He has received many honors, including the 1995 Illinois Community College Trustees Association's Faculty Award and the Teaching Excellence Award from the National Institute for Staff Organizational Development. Professor Berkson is considered one of the country's leading authorities in the field of creative thinking, and is the author of The Different Drummer Handbook, Marching to the Creative Beat.

Denis, who is a father of a child with Cerebral Palsy, has worked with organizations serving people with special needs. He has done programs for groups such as Pathways Center for Children, and appeared with his family in videos such as: "Is My Baby OK?" and a how-to video on computer usage for children with challenges. Denis is a self-declared spokesman for the power and potential of individuals who are challenged.

9:00 pm Late Night Entertainment with Elvis

Ballroom

Join conference attendees after the dessert reception to enjoy the music of Elvis. Junior Talley has been performing his "Illusions of Elvis" show since 1991. He has been a world finalist in the Images of Elvis competition held in Memphis, Tennessee every August during Elvis week. He was the featured Elvis impersonator in "The Men Who Would Be King" film shown on the

Learning Channel across the United

States in February. His goal is to keep the Elvis name alive forever . . . and with fans help, keep the artist of the century, "Elvis Aaron Presley" alive for centuries to come. You won't want to miss this exciting late night show.



Special Events continued

Friday • October 12

9:00 am – 10:30 am General Session — Ballroom

Contegrity—Why We Do What We Do, The Way We Do It, and How We Know We Did It.

Judy Harris Helm, Ed.D., Best Practices, Inc.

Are children engaged in their learning? Is time well spent in the classroom? Are professionals doing more assessing than teaching? Are children learning what they need to learn? How do you know? "Contegrity – Why We Do What We Do, The Way We Do It, and How We Know We Did It" introduces the concept of contegrity . . . the art of teaching with continuity and integrity in the classroom. With children's work and anecdotes from real classrooms, Dr. Helm challenges professionals to stop and think where they put their efforts and how they spend children's precious time. Friday's general session looks at engaged learning, curriculum and assessment in the classroom.



Judy Harris Helm, Ed.D. is Associate Professor of Early Childhood Education at National-Louis University in Evanston, Illinois. She began her career teaching first grade then taught, directed, and designed early childhood and primary programs as well as trained teachers at the community college, undergraduate, and graduate levels. She served on the Task Force for the design of the Valeska Hinton Early Childhood Education Center, a state of the art urban collaboration school for children age three through first grade in Peoria, Illinois, where she became Professional Development Coordinator for the school. Dr. Helm is co-author of Windows on Learning: Documenting Children's Work, Teacher Materials for Documenting Children's Work, and Young Investigators: The Project Approach in the Early Years.

Showcasing

Come see what's being done in Illinois to serve young children and their families. Your colleagues will display and discuss a variety of techniques, successful strategies, ideas for family involvement, and innovative practices being used with young children.

This is a wonderful opportunity for networking and exchanging ideas. Showcasing sessions are scheduled for Thursday morning and afternoon, October 11, and Friday morning, October 12.

SHOWCASING I

THURSDAY, OCTOBER 11 • 8:30–11:30 A.M.

SENSORY LEARNING

Karen Bender and Linda Ponce, School District U-46

FUN-NITURE

Judy O'Hare, Chicago Board of Education

THE BRAILLE LEARNER: STRATEGIES THAT HELP

Les Stevens, Illinois School for the Visually Impaired

HIGHLIGHTING EDUCATION AND RESOURCES (H.E.A.R.)

Charlotte Denight and Barbara Fiedler, ISD – H.E.A.R.

SHOWCASING II

THURSDAY, OCTOBER 11 • 1:00–4:00 P.M.

MALE INVOLVEMENT PROGRAM

Linda Ruhe and John Tolliver, Two River HeadStart Agency

ALTERNATIVE SERVICE DELIVERY MODELS FOR E.C. STUDENTS

Lea Ann Frost and Diane Schiappacosse, SEDOL
(Special Education District of Lake County)

ENHANCING COMMUNICATION WITH PICTURE COMMUNICATION SYMBOLS

Ellen Klatt and Paula Black, Principal, Seward Elementary,
Winnebago School District 323

DEVELOPING PRE-LITERACY SKILLS USING CLASS BOOKS

Colleen Ptaszynski, Consolidated School District #301

SHOWCASING III

FRIDAY, OCTOBER 12 • 8:30–11:30

ELiTeC II

Kate McGruder, WIU, Center for Best Practices in
Early Childhood Education

EXPLORING MATH, SCIENCE AND SOCIAL STUDIES CONCEPTS WITH TECHNOLOGY

Amy Betz and Letha Clark, WIU, Center for Best Practices in ECE

I CAN DO IT—YOU CAN TOO! MAKE THE ARTS

ACCESSIBLE FOR ALL CHILDREN

Judy Potter and Merriam Guzman, Center for Best Practices in ECE,
WIU, Center for Best Practices in ECE

FAMILY ACTIVITY PACKS

Jan Dell, S.A.S.E.D

STARTING OR IMPROVING YOUR TOY LENDING LIBRARY

Linda Baugher, Private Provider Birth-3 program DeKalb



Jill Connors

**2941 Old Freeburg Road
Belleville, Illinois 62220
618-233-9519 (telephone)
toys@peaknet.net (e-mail)**

**Educational toys, games, books
and five-star software
Home Workshops, Catalog Orders**

Fun, Flexible, Home-based business opportunity

Table Talks

Table Talks will give attendees the opportunity to discuss “hot” topics and will be featured during Session IV workshops on Thursday afternoon and early Friday morning.

THURSDAY, OCTOBER 11 • 3:15 PM – 4:45 PM

Birth to 3 Issues: What's Hot? • Capitol I

This table talk will focus on current developments in the Illinois Early Intervention System. An update on the latest policies and procedures for serving infants and toddlers with disabilities and their families will be discussed. Service providers, administrators and trainers will also have the opportunity to share ideas to improve their practice.

Therese Wehman, Ph.D., Elmhurst College

Elizabeth Delaney, Ed.D., University of Illinois at Chicago

Children with Special Needs in the Early Childhood Classroom – Making It Work • Capitol II

In this table talk, attendees will discuss the issues, concerns, and rewards of including children with special needs in early childhood settings. Philosophy as well as the “how to’s” will be covered.

Donna Nylander, Prairie Children’s Preschool, Naperville

The Parent Connection • Capitol III

This table talk will focus on parent issues and resources. Parent involvement and parent/professional partnerships will also be addressed.

Joan Debelak, StarNet Region VI

What's Ahead for 3-5s? • Capitol IV

During this table talk, participants will have the opportunity to discuss Illinois’ current 3-5 programs, with a focus on PreK at Risk. Where we are now and where we hope to be will be addressed.

Sally Tudor and Suzanne Dillow, Illinois State Board of Education

Technology for Young Children • Capitol V

This table talk will explore, through interactive discussion, ideas for integrating technology into preschool classrooms. Together, participants will learn to utilize technology for learning throughout the curriculum and classroom environment.

Marlene Christ, StarNet Region VI

FRIDAY, OCTOBER 12 • 8:00 AM – 8:50 AM

Child Find — How To Do It Right? • Capitol I

This table talk will focus on Child Find and public awareness activities and procedures for local school districts in collaboration with early intervention.

Pam Reising-Rechner and Chris Lehl, Illinois State Board of Education

Teaching Little Ones to “Read”: Literacy Activities in the PreK Classroom • Capitol II

Meet with a teacher of at-risk 3-5 year olds who integrates and implements best literacy practices. Discuss and share examples of “how it’s done.”

Sandra Black, Cass School District

What's New in EI? • Capitol III

This table talk will focus on current developments in the Illinois Early Intervention System. An update on the latest policies and procedures for serving infants and toddlers with disabilities and their families will be discussed. Service providers, administrators and trainers will also have the opportunity to share ideas to improve their practice.

Therese Wehman, Ph.D., Elmhurst College

Elizabeth Delaney, Ed.D., University of Illinois at Chicago

Hot Off the Press! The Illinois Early Learning Standards • Capitol IV

Come and discuss the Learning Standards recently developed by ISBE for use in all settings serving 3-5 year olds.

Shelby King, Illinois State Board of Education

Promoting Best Practices in the Primary Grades • Capitol V

Talk with a principal who, together with her team, has worked to change the culture of their primary classrooms to ensure that children are actively involved, thinking, making choices, and learning.

Cindy Carlson, Roodhouse Elementary

CONTINUING EDUCATION CREDIT

Conference attendees may receive continuing education credit in the following areas:

Speech-Language Pathologists and Social Workers may receive continuing education hours for renewal of their license through the Illinois Department of Professional Regulation.

Teachers may receive Continuing Professional Development Units (Illinois State Board of Education) toward the renewal of their teacher certificate.

Early Intervention Providers may earn hours toward the Early Interventional Credential by attending designated sessions.

Please refer to the Continuing Education/Credentialing packet in your folder for complete instructions.

CONFERENCE STORE

Need a place to get away and have some fun? Need to relax? Want to meet other early childhood professionals? You’ll find all of these opportunities and more at the “Sharing a Vision Conference Store,” found in the Exhibit Area. Make plans to join us there!!!!

AWESOME PRIZES

Guess the Sharing A Vision Secret Word and you could be a winner! Come and check out the Conference Store in the Exhibit area for your chance to win great prizes! Use the card in your conference packet to enter to win. Drawings will be held frequently, so check back often to see if you’re a winner. Good Luck!!!



Workshops•Thursday•October 11

HALF DAY SESSION • THURSDAY AM • 8:00 AM – 12:00 PM

Successful Learning Strategies for Children with Autism (Birth-5)

Marrea Winnega, Ph.D., Clinical Psychologist

Mary Coughlin, MS CCC-SLP, Speech/Language Pathologist

A.E.R.O. Special Education Cooperative

A multi-modal approach has been found to be successful in teaching students with autism. The audience will learn about two effective strategies – TEACCH and Discrete Trial – for teaching young students with autism. Learning characteristics of children with autism will be described. The use of these strategies is a foundation for students with autism to learn a variety of skills.

WORKSHOP SESSION I • THURSDAY AM • 8:00 AM – 10:00 AM

The Best of What We Know: Supporting Young Children's Early Literacy Interests and Abilities (3-8)

Kathy Barclay, Ph.D., Chair, Department of Curriculum and Instruction, Western Illinois University, Macomb

Early childhood teachers, caregivers, and parents can make all the difference in the world when it comes to helping young children develop into readers and writers. In this session, we'll look at research-based strategies for promoting: (1) oral language and phonological awareness, (2) concepts about print, books and stories, and (3) written language development.

The Project Approach and the Illinois Learning Standards (3-8)

Sallee Beneke, MEd., Professor, Illinois Valley Community College

This presentation will explain the Project Approach and will provide practical answers to commonly perceived obstacles in implementing the Project Approach, including scheduling, meeting the Illinois Early Learning Standards, children with limited experiences, inclusion, and part-day programs. Examples from projects completed in classrooms for children 3-8 will be shared.

Teachers Talk Tech (3-8)

Support Staff, Center for Best Practices in Early Childhood Education

Classroom teachers who are accomplished technology users will share strategies and activities from their classrooms. Join an interactive session as teachers from the trenches discuss technology and young children.

Integrating Art into the Early Childhood Curriculum: Nudging and Nurturing the Creative Spirit (3-5)

Darlene Crampton-Fahrenkrog, Ph.D., Professor of Art, Concordia University, River Forest

This presentation will focus on developmentally appropriate activities, methods and materials that support individual creative expression.

Everyday Heroes: Working with Children with Traumatic Brain Injury (Birth-8)

Sharon Gage, Parent Resource Specialist, StarNet Region IV

Lynette Gage, Student

Lynette Gage received a traumatic brain injury at age 10 and was in a coma for nearly three months. She will present a first-person perspective of TBI. Participants will receive an overview of traumatic brain injury which includes information for writing functional and effective

education plans and dealing with challenging behaviors. Participants will learn the importance of parents and professionals working together to identify and develop strategies for home and classroom to meet the unique needs of the child with TBI.

The ABCs of Storytelling: Storytelling 101 (Birth-8)

Linda Gorham, Story Teller

Storytelling is the art of verbally, physically and imaginatively revealing a story to an audience. People tell stories all the time. They have fond memories of sitting around the kitchen table sharing stories. It is amazing how those stories repeated over and over again bring back such good, warm (and sometimes crazy) memories. Storytelling is an art on the rise. More and more people are interested in sharing memories, and passing along the values learned through stories. Anyone can tell a good story. Really! Telling a story simply takes a little imagination, some knowledge of the basics, and a willingness to try. It's a viable option for everyone, if they just explore the possibilities and learn the A, B, C's. This workshop will be a combination of lecture and story plus group exercises.

Understanding Difficult Behavior: Why Does He Do That? (3-5)

Becky Handler, SLP, and Nancy Pufahl, Resource Specialists, StarNet Region VI

How can we begin to READ the messages children's misbehavior may be communicating? Behavior is complex and is influenced by many factors. During this informative session, participants will be made aware of 3 messages commonly conveyed by children's misbehavior. This discussion will demonstrate that misbehavior has meaning and serves a function for the child.

Getting to Know You: Birth-3 and 3-5 Transition (Birth-5)

Sandy Heins, Early Intervention Training Specialist, Provider Connections

The Individuals with Disabilities Education Act calls for a "smooth and effective transition" from Part C (birth-3 year olds) services in natural environments to Part B (3-5 year olds) services in the community. This outcome requires family participation, local administrative networking, organization, and collaboration. This workshop will provide an opportunity to learn of the various roles individuals have in the transition process under state and federal expectations.

Motor Development in the Young Child (Birth-8)

Sue Kirchgessner, PT, MS, Consultant

Participants will learn about typical and atypical motor skill development from infancy through early childhood. Activities, strategies and adaptations that enhance and support motor skill development for all children will be shared.



Workshops•Thursday•October 11

“Wow, Look What These Kids Can Do!” (Birth-3)

Joan Leff, Early Childhood Resource Specialist and Connie Shugart, Early Childhood Resource Specialist, StarNet Regions I and III

This interactive session involving group discussion and small group activities will look at the amazing world of infant/toddler development. Session leaders will discuss the acquisition of skills at various age levels and participants will visualize the growth process. Discussion will show how one area of development affects another and how the development of each skill builds the foundation for others. Areas of development addressed will include emotional, cognitive, motor, language, and adaptive.

DEC Recommended Practices in Early Intervention/Early Childhood Special Education (Birth-5)

Mary McLean, Ph.D., Professor, Department of Exceptional Education, Director of the Early Childhood Research Center, University of Wisconsin-Milwaukee

Michaelene Ostrosky, Ph.D., Associate Professor, Department of Special Education, University of Illinois, Urbana-Champaign
Participants will become knowledgeable about the process followed in the development of the DEC Recommended Practices, the practices themselves, and three products based on the practices: a self-assessment for practitioners, a parent checklist, and an administrator's guide.

Understanding Speech and Language Delays in Children Birth-8 (Birth-8)

*Debra Reichert Hoge, Ed.D., Professor
Department of Special Education and Communication Disorders
Southern Illinois University, Edwardsville*

During this session, participants will learn to identify the differences between speech and language as they investigate typical development and the specific areas in which delays can occur.

In the Business of Growing Brains: Infant Brain Development (Birth-5)

Jennifer Rosinia, MEd., OTR/L, KidsLinks Unlimited, Inc.

Did you know you were in the business of growing brains? If you care for or work with young children, you are! There have been remarkable advancements and findings in the neurosciences during the past decade. We know more than we ever have about the importance of the first years of life. Learning about the ways in which an infant's brain develops will amaze you, touch you, and will reinforce the importance of your work with very young children.

Collaboration is Like . . . (Birth-8)

*Gina Ruther, Director
Gennie Gilmore, IDHS Head Start Collaboration*

In this session, participants will learn the basic steps of the collaborative process, various models of full day/year collaborations, and get an overview of what the Head Start collaboration office does. Participants will also have the chance to network with each other to share collaborative experiences.

Shared Literacy (3-8)

*Pam Scranton, Teacher, Discovery Preschool,
Northminster Learning Center
Mary Ann Gottlieb, MS.Ed., Teacher,
Valeska Hinton Early Childhood Education Center*

This presentation is designed for Pre-K and Primary teachers who want to know more about the Shared Reading & Writing Process. Presenters will provide theory and research behind the process, describe the process itself, and take attendees through a typical Shared Reading session. Attendees will come away from the presentation ready to implement shared literacy in their classrooms.

The Impact of Deafness on Young Children in Illinois (Birth-8)

*Barb Sims, Consultant, Illinois Service Resource Center
Nancy Scott, Hearing Specialist, Hearing and Vision Connections*
After attending this workshop, participants will have a better understanding of the implications of a hearing loss on young children and the supports and services available in Illinois. Topics covered include hearing loss, stimulation, and discussion on how to prevent the pyramid of deficits through timely identification, amplification, intervention and family support. Legal guidelines as well as best practice applications will be reviewed.

Making the Switch from Traditional to Play Based Screening or Stepping Out of The Darkness and Into The Light (3-5)

*Sharon Winnett, MS/SLP, Early Childhood Programs Coordinator,
Hillsboro Community Unit Dist. #3
Kim Draper, MS/SLP, Speech-Language Pathologist,
Hillsboro Pre-Kindergarten Program*

The presenters will take the attendees on a brief trip back through time to what they consider to be the “Dark Days” of their district's screening of young children using traditional screening instruments. They will move participants along through their discovering what is right for young children and the commitment to change, which brought their district into the “Light” of using the children's natural affinity for play as the medium for screening. Participants will be given information and materials to go back to their districts to begin making the changes necessary to move to a more appropriate, child and family-friendly screening process.

WORKSHOP SESSION II • THURSDAY AM • 10:15 AM – 12:00 PM

Foundations for Successful Inclusion: Knowledge, Skills, and Dispositions (3-8)

Cecelia Benelli, Ph.D., Professor, Western Illinois University, Macomb
Dr. Benelli will share the preliminary results of a study of the essential knowledge, skills, and dispositions for inclusion to be a successful experience for all concerned. Participants will learn about the practices and beliefs of teachers who are currently teaching in inclusive settings and gain insight into necessary elements for it to succeed.

Learning from Reggio's Approach to Inclusion: An Outstanding Education for All Children (Birth-8)

Tess Bennett, Ph.D., Director, Great Lakes Quality Improvement Center for Disabilities (QIC-D), University of Illinois, Urbana-Champaign
This presentation will introduce participants to Reggio Emilia's outstanding system of care and education for young children. Key princi-

Workshops•Thursday•October 11

ples and strategies for inclusion will be discussed based on Reggio beliefs about how children learn and as a model for inclusion.

Shift Happens: Resources for Infusing New Content and Capabilities in Teaching/Training Practices (Birth-8)

Camille Catlett, MA. and Frank Porter, Graham Child Development Center, University of North Carolina

This session will provide participants with methods and materials for supporting changes in practice suggested by the new DEC Recommended Practices. High-quality, low-cost resources for teaching, training, and staff development will be shared. Emphasis will be placed on family-practitioner collaboration, serving culturally and linguistically diverse children and families, and service delivery in diverse community settings.

Boxed In? Box Out! (3-8)

Support Staff, Center for Best Practices in Early Childhood Education
Is your classroom in a box? There's the sensory table, the block area, the art area, the writing center, the computer area, and more. Join in a discussion of the physical environment associated with setting up a computer center in a classroom setting.

A Friendly Approach to Math for Families (5-8)

Ruth Champagne, Ph.D. Professor of Math, Concordia University, River Forest

This session will provide strategies, activities and games to help teachers and families explore and enjoy math in a friendly way with children in grades K-3. Topics will include visual thinking, shape puzzles, pattern puzzles, sorting, comparing, counting and exploring addition, subtraction, multiplication and division.

Repeated Story Reading to Promote Early Literacy (3-5)

Susan Fowler, Ph.D., Professor and Dean of the College of Education, University of Illinois, Urbana-Champaign

This informative session will focus on how teachers can develop a curricular strategy to support young children's emerging literacy through repeated reading of a story and the development of art, music and dramatic play activities that extend concepts and themes from the story. Stories are selected that portray diverse cultures, races and languages. Strategies for developing curriculum for individual classrooms will be stressed and samples provided.

Time-Tested and Current Brain Research and Learning Theory (Birth-8)

Raymond J. Golarz, Ed.D., Consultant

This session will center upon brain research and learning theory, focusing upon the belief system of adults and society and the impact those beliefs have upon children throughout their lives.

The New Multi-Tier Certification System (Birth-8)

*Elizabeth Hanselman, Principal Accountability Specialist
Division of Professional Certification, Illinois State Board of Education*

This session will provide the latest information on certification policies and practices including the new levels of certificates, the exchange of certificates, and continued professional development for teachers. Participants will have an opportunity to ask questions on all of these topics.

Learning In The Great Outdoors (3-8)

Rhoda Hayes, Teacher, Macomb CUSD #185 PreK

Ronda McKee, Teacher, Northwestern CUSD #175 PreK

Birds are singing. Flowers are blooming. Children are chasing and laughing with butterflies. Young children are naturally curious, but sometimes they do not have the opportunity to interact with nature at home. School districts have created natural playground habitats for children to explore. This presentation will focus on how to develop natural play settings with parent and community support, incorporating Illinois Learning Standards in the process.

Oral Sensory Motor Development and Its Impact on Learning Eating and Speaking (Birth-5)

*Sue Justice, MA, SLP, Pediatric Developmental Rehabilitation
Children's Hospital of Illinois-Peoria*

This presentation will give an overview of oral-sensory-motor (OSM) development, its impact on early learning, feeding, and speech-language development. OSM dysfunction and general treatment considerations/approaches will be discussed. This program is designed for new and experienced educators, therapists, or families wishing to familiarize themselves with OSM issues. Participants will learn to identify abnormalities in OSM development and how to manage intervention.

Illinois Birth to Three Program Standards (Birth-3)

Christine Lehl, Principal Consultant, Division of Early Childhood Education, Illinois State Board of Education

The Birth to Three Program Standards reflect knowledge, research findings, and shared beliefs about high quality, developmentally appropriate early childhood care and education in the context of programs for infants, toddlers and their families. Implementing these standards and corresponding quality indicators provide a foundation to support children's growth and development as well as physical, emotional, social and cognitive well-being, leading to successful learning for each child.

Ages and Stages Questionnaire (ASQ): Parent Completed Child Monitoring System (Birth-5)

*Lynn R. Liston, Ed.D, Coordinator for Pediatric Specialty Services
Rockford Memorial Hospital*

This workshop will present general information about screening and assessment, including the components of a screening program, factors to consider when reviewing screening information, the requirements of IDEA, and how the use of the ASQ can enhance Child Find efforts. Information regarding the development of the ASQ system, the accuracy of parent report, and cultural sensitivity and flexibility of the tool will be presented. Participants will practice scoring and view a video illustrating the use of the ASQ in a home.

Effective Behavior Management (Birth-8)

*Keith Neuber, MS, CEO, Alton Day Care and Learning Center
President of I.K.A.N. Presentations*

This workshop is designed to help caregivers better understand and manage the behavior of children through the practical concepts of Systems Theory to provide insight into issues of power and control, setting limits, recognizing functional and dysfunctional behavior patterns, and motivating children to change. The examples will focus on situations such as temper tantrums, resistance to authority, underachieve-

Workshops•Thursday•October 11

ment, acting out behavior, task avoidance, back talk, and a variety of problems routinely encountered by parents.

... And Then Came Grant (Birth-5)

Julie Reiniche, Teacher, Nancy Hull, Speech Language Pathologist, Jane Jaroz, Occupational Therapist, Prairie Children Preschool/Indian Prairie School District 204, Naperville
Cristin Carlson, Parent (Grant's mom)

You know the benefits of an inclusive model, now find out how an integrated approach of teacher, speech/language pathologist, occupational therapist and parent meet one child's needs in an inclusive classroom. The team will share strategies, successes and struggles as Grant becomes part of the classroom community. Grant's journey begins with parent meetings to classroom experiences to transition to kindergarten. The parent's hopes and dreams for her son will be highlighted.

The Illinois Early Learning Project: Bright Futures Start Here! (Birth-8)

Dianne Rothenberg, MS, Co-Director, ERIC Clearinghouse University of Illinois, Urbana-Champaign

The Illinois Parent Information Network (formerly NPIN Illinois) has a new look and a new name. Come find out how this statewide resource can help you and the families you work with.

Books, Books, Books: New Children's Books for Birth – 5 (Birth-5)

Sarah Sebert, Principal Education Consultant, ISBE-Chicago, Division of Early Childhood
Mary Trieschmann, MS Ed., Director of Education and Exhibits, Kohl Children's Museum, Wilmette

The best new books for children ages birth through five will be presented and available for review. Participants will become familiar with new books suitable for classroom purchase and recommendation to parents. Qualities and characteristics of what makes a book worthwhile will be presented.

What Forrest Gump Has to Teach Us: Multiple Intelligences Comes to Life (5-8)

Pandora Taylor, MA-Ed Administration, Vicki Niswander, BS, Julie Schackmann, MS-Ed, Nancy Spejcher, MS-Ed, Project CHOICES Team 4
This interactive workshop will bring the theory of multiple intelligences to life. An introduction to the eight intelligences will help participants identify different ways of learning. Using a variety of examples and activities to illustrate the eight intelligences, participants will experience a blend of theory and practical application.

Music is Magic Throughout the Day (3-5)

Ingeborg Teske, Assistant Principal, St. James Lutheran School and Adjunct Faculty Member at Concordia University

A variety of music activities can be incorporated daily in an early childhood classroom. Songs, chants, movement, rhythm instruments, and using music for transition will be included. Come ready to participate.

HALF DAY SESSION • THURSDAY PM • 1:30 PM – 4:45 PM

Developing Effective Communication of Children with Autism (Birth-5)

Mary Coughlin, M.S. CCC-SLP, Speech/Language Pathologist

Marrea Winnega, Ph.D., Clinical Psychologist

A.E.R.O. Special Education Cooperative, Burbank

Children with autism often have difficulty in communicating. All areas of speech and language can be affected including oral-motor, articulation, auditory comprehension, verbal language, and social-pragmatic skills. The audience will learn about specific communication characteristics associated with autism and techniques for their remediation.

WORKSHOP SESSION III • THURSDAY PM • 1:30 PM – 3:00 PM

Using Functional Assessment and Positive Interventions to Understand and Address the Challenging Behavior of Young Children (3-8)

Lynette Chandler, Ph.D., Associate Professor, Early Childhood Special Education, Northern Illinois University, DeKalb

This session will present positive and practical strategies for early childhood educators and parents to use in preventing and remediating challenging behavior. The session will focus on using functional assessment to understand why children do what they do and selecting positive intervention strategies that will promote appropriate behaviors that will replace challenging behavior.

Where the Wild People Are (3-8)

Support Staff, Center for Best Practices in Early Childhood Education

As an introduction to this session, indicators of quality software for young children will be highlighted. Participants will then organize into small groups, each group with access to a computer. The groups will review and evaluate assorted software programs and develop integrated curriculum activities based on the software. Individual groups will share with the large group their software evaluations and integrated activities.

Making a Project Work in YOUR Classroom! (3-5)

Kiersten Crafton and Sharon Andersen, Teachers, Prairie Children's Preschool/Indian Prairie School Dist. 204, Naperville

You've gotten an introduction to the Project Approach . . . you think it's a great idea . . . but are you wondering how to begin? How can the Project Approach work with children with special needs? These questions will be answered through examples and discussion of personal experiences, common obstacles, and suggestions to overcome them, as well as strategies for including all children in projects.

Only a Parent Would Know: Family Dynamics and Parenting Strategies (Birth-8)

Kathy Ellinor, Child & Family Connections & Parent

Mary Smith, Family Resource Specialist & Parent

Sandy Valentine, Resource Specialist and Parent

StarNet Regions I and III

Jacque Mace, Parent and Laura Black, Parent

Only a parent would know the different issues in raising a child with special needs. Learn different parenting strategies these panelists have used in raising their families.



THURSDAY MORNING HALF DAY SESSION (8:00 A.M. – 12:00 P.M.)

		ROOM	LOCATION
Winnega/Coughlin	Successful Learning Strategies for Children with Autism	Governor	Level 3

THURSDAY SESSION I WORKSHOP SESSIONS (8:00 A.M. - 10:00 A.M.)

		ROOM	LOCATION
8:30 am – 11:30 am	Showcasing I	Prefunction Area	Level 2
Barclay	The Best of What We Know: Supporting Young Children's Early Literacy	Emerald	Level 2
Beneke	The Project Approach & the Illinois Learning Standards	Diamond	Level 2
Center for Best Practices	Teachers Talk Tech	Plaza C	Level 1
Crampton-Fahrenkrog	Integrating Art Into the Early Childhood Curriculum	Ruby	Level 2
Gage/Gage	Everyday Heroes: Working with Children with Traumatic Brain Injury	Capitol III	Level 3
Gorham	The ABC's of Storytelling	Plaza E	Level 1
Handler/Pufahl	Understanding Difficult Behavior: Why Does He Do That?	Plaza B	Level 1
Heins	Getting to Know You: Birth-3 & 3-5 Transition	Sangamon	Level 3
Kirchgessner	Motor Development in the Young Child	Capitol V	Level 3
Leff/Shugart	Wow, Look What These Kids Can Do!	Plaza D	Level 1
McLean/Ostrosky	DEC Recommended Practices in EI/EC SE	Capitol II	Level 3
Reichert Hoge	Understanding Speech & Language Delays in Children Birth-8	Plaza F	Level 1
Rosinia	In the Business of Growing Brains: Infant Brain Development	Sapphire	Level 2
Ruther/Gilmore	Collaboration is Like....	Capitol IV	Level 3
Scranton/Gottlieb	Shared Literacy	Illinois	Level 3
Sims/Scott	The Impact of Deafness on Young Children in Illinois	Capitol VI	Level 3
Winnett/Draper	Making the Switch from Traditional to Play Based Screening	Capitol I	Level 3

THURSDAY SESSION II WORKSHOP SESSIONS (10:15 A.M. - 12:00 P.M.)

		ROOM	LOCATION
Benelli	Foundations for Successful Inclusion	Plaza B	Level 1
Bennett	Learning from Reggio's Approach to Inclusion	Capitol II	Level 3
Catlett	Shift Happens: Resources for Infusing New Content & Capabilities in Teaching/Training Practices	Plaza A	Level 1
Center for Best Practices	Boxed In? Boxed Out!	Plaza C	Level 1
Champagne	A Friendly Approach to Math for Families	Capitol V	Level 3
Fowler	Repeated Story Reading to Promote Early Literacy	Illinois	Level 3
Golarz	Time-Tested & Current Brain Research & Learning Theory	Plaza F	Level 1
Hanselman	The New Multi-Tier Certification System	Capitol IV	Level 3
Hayes/McKee	Learning In The Great Outdoors	Plaza D	Level 1

What, when, where ... SAV Workshops, times and locations

16

THURSDAY SESSION II WORKSHOP SESSIONS (10:15 A.M. - 12:00 P.M.)

ROOM

LOCATION

Justice	Oral Sensory Motor Development	Plaza E	Level 1
Lehl	Illinois Birth to Three Program Standards	Sapphire	Level 2
Liston	Ages & Stages Questionnaire (ASQ)	Capitol I	Level 3
Neuber	Effective Behavior Management	Emerald	Level 2
Reinicke/Hull/Jaroz/Carlson	...And Then Came Grant	Capitol III	Level 3
Rothenberg	The Illinois Early Learning Project: Bright Futures Start Here!	Capitol VI	Level 3
Sebert/Trieschmann	Books, Books, Books: New Children's Books for Birth-5	Diamond	Level 2
Project CHOICES Team 4	What Forrest Gump Has to Teach Us	Sangamon	Level 3
Teske	Music is Magic Throughout the Day	Ruby	Level 2

THURSDAY AFTERNOON HALF DAY SESSION (1:30 P.M. – 4:45 P.M.)

ROOM

LOCATION

Winnega/Coughlin	Developing Effective Communication of Children with Autism	Governor	Level 3
------------------	--	----------	---------

THURSDAY SESSION III WORKSHOP SESSIONS (1:30 P.M. – 3:00 P.M.)

ROOM

LOCATION

1:00 pm – 4:00 pm	Showcasing II	Prefunction Area	Level 2
Chandler	Using Functional Assessment & Positive Interventions	Plaza B	Level 1
Center for Best Practices	Where the Wild People Are	Plaza C	Level 1
Crafton/Andersen	Making a Project Work in YOUR Classroom!	Emerald	Level 2
Ellinor/Smith/Valentine/Mace/Black	Only a Parent Would Know: Family Dynamics & Parenting Strategies	Ruby	Level 2
Fabian/DeLuna/Patlan	Working With Hispanic Families	Capitol IV	Level 3
Frisbie	Keeping House & Driving Trucks: Social Emotional Development	Sapphire	Level 2
Gerriettes	Moving Through the Medical Coverage Maze for Families	Capitol VI	Level 3
Hertzog	Opportunities for Creativity in an Early Childhood Curriculum	Diamond	Level 2
Jorgenson/Slaght	Vision Accommodations	Capitol III	Level 3
Ostrosky	Assessing Preschoolers – Purposes, Questions & Tools	Illinois	Level 3
Rockwell/Reichert Hoge/Searcy	Embedding Literacy & Language into Current Curriculum	Plaza F	Level 1
Ross	UCP Chicago's First Tech Touch	Capitol II	Level 3
Salisbury/Delaney	Thinking Systemically, Acting Inclusively	Sangamon	Level 3
Santos/Corso	Collect, Select, & Reflect: Adapting Practices & Materials	Capitol V	Level 3
Scranton	Overview of the Work Sampling System	Plaza E	Level 1
Shugart/Smith/Leff	It's Okay to Play, Because Play is the Way!	Plaza D	Level 1
Yates	Using Developmental Observation Topics	Capitol I	Level 3

THURSDAY SESSION IV WORKSHOP SESSIONS (3:15 P.M. – 4:45 P.M.)

		ROOM	LOCATION
Center for Best Practices	Move Over Photocopier, Scissors & Glue	Plaza C	Level 1
Gattone	Seizure Disorders & Children	Plaza B	Level 1
Gorham	Storytelling for the Classroom	Plaza E	Level 1
Kreiss	America's Playgrounds	Sangamon	Level 3
Martin/Sisney	Our Journey With the Reggio Emilia Process	Plaza D	Level 1
Morrison	Special Education Rules: Answers & Questions	Ruby	Level 2
Murphy Boston	How to Slow Down & Be Focused in a Harried World	Plaza F	Level 1
Piper	Science for Preschoolers	Emerald	Level 2
Rosinia	Self-Regulation: A Sensory Approach	Sapphire	Level 2
Smith/Slaght	SOS – Support Our Siblings	Capitol VI	Level 3
Steinman	Work It Out- Resolving Conflicts Peaceably	Diamond	Level 2
Tompkins/Quesenberry	Interagency Agreements: Top Ten Do's & Don'ts	Illinois	Level 3
Table Talk	Birth to 3 Issues: What's Hot?	Capitol I	Level 3
Table Talk	Children With Special Needs in the Early Childhood Classroom – Making It Work	Capitol II	Level 3
Table Talk	The Parent Connection	Capitol III	Level 3
Table Talk	What's Ahead for 3-5s?	Capitol IV	Level 3
Table Talk	Technology for Young Children	Capitol V	Level 3

FRIDAY SESSION I WORKSHOP SESSIONS (10:45 A.M. – 12:15 P.M.)

		ROOM	LOCATION
8:30 am – 11:30 am	Showcasing III	Prefunction Area	Level 2
Barclay	They Got the Main Idea....But Missed the Meaning	Governor	Level 3
Berkson	New Leaps, Less Boundaries	Plaza F	Level 1
Brady	Home Visiting is More Than Going to the Home	Emerald	Level 2
Catlett/Reichert Hoge	Shorter Than a Snooze....Quick & Effective Staff Development Ideas	Plaza A	Level 1
Doubet	A Panel Discussion: Blending Pre-Kindergarten At-Risk & ECSE	Ruby	Level 2
Fisher/Kluzik Stauch	The Transition from Part C to Part B Services	Capitol I	Level 3
Gattone	Seizure Disorders & Children (Repeat)	Capitol VI	Level 3
Gronlund	Focused Portfolios	Plaza D	Level 1
Hinton/Lyman	A Vision of Caring Schools	Capitol III	Level 3
Klein/Blank	Critical Thinking Through Project Work in EC Settings	Illinois	Level 3
Lucas	Everybody Can Dance & Every Body Can Dance!	Plaza E	Level 1
Nall	Developmental Continuity in Early Childhood	Plaza C	Level 1

What, when, where . . . SAV Workshops, times and locations

18

FRIDAY SESSION I WORKSHOP SESSIONS (10:45 A.M. – 12:15 P.M.)

ROOM	LOCATION
Sapphire	Level 2
Capitol II	Level 3
Diamond	Level 2
Capitol IV	Level 3
Capitol V	Level 3
Plaza B	Level 1

FRIDAY SESSION II WORKSHOP SESSIONS (1:30 P.M. – 3:00 P.M.)

ROOM	LOCATION
Capitol IV	Level 3
Ruby	Level 2
Plaza A	Level 1
Plaza B	Level 1
Sangamon	Level 3
Plaza F	Level 1
Plaza D	Level 1
Emerald	Level 2
Illinois	Level 3
Capitol II	Level 3
Plaze E	Level 1
Diamond	Level 2
Capitol VI	Level 3
Capitol I	Level 3
Plaza C	Level 1
Sapphire	Level 2
Capitol III	Level 3
Capitol V	Level 3
Governor	Level 3

Workshops•Thursday•October 11

Working With Hispanic Families (Birth-5)

Claudia Fabian, BA, Education Coordinator; Elva DeLuna, Early Childhood Education Manager; Olivia Patlán, Grantee's Family Services Manager, Illinois Migrant Head Start Project

This workshop will provide participants with general information on working with Hispanic families, focusing on seasonal and migrant agriculture working families with children under six years old. Topics include migrant lifestyles, family customs, cultural values, educational expectations, and the description of Migrant Head Start services provided to these families.

Keeping House and Driving Trucks: Social Emotional Development in the Early Childhood Years (Birth-8)

Elizabeth Frisbie, MA, MEd, EC Consultant/Behavior Specialist Education for Change

This session will discuss the typical pattern of social-emotional development in young children and how this pattern varies for boys, girls, and children exposed to risk factors such as violence, poverty or neglect. Ideas for supporting healthy social emotional development in young children will also be presented.

Moving Through the Medical Coverage Maze for Families with Children with Special Health Care Needs (Birth-8)

Jeanne Gerriets, BS, MS, Campaign for Better Health Care, Champaign

During this workshop discussion will focus on:

- Your rights as a family with a child with special health care needs;
- Your health coverage options and an explanation of the differences;
- Programs and organizations which exist to assist families;
- How to be an advocate for your child and your family

Opportunities for Creativity in an Early Childhood Curriculum (3-8)

Nancy Hertzog, Ph.D., Assistant Professor, Department of Special Education, University of Illinois, Urbana-Champaign

During this session, the presenter will discuss, demonstrate, and engage the audience in activities that examine the features of a creative early childhood environment. The audience will see many examples of children engaged in creative activities and will create an Action Plan for enhancing creativity in their classrooms.

Vision Accommodations (Birth-8)

Catherine Jorgenson, Teacher and Roseann Slaght, Family Resource Specialist, StarNet Regions I and III

Participants will learn about different types of vision loss and how it impacts learning. Strategies and accommodations that are used when working with children who are blind and visually impaired will be shown. The presenters will assist participants in locating resources in their communities and share tools and tips for success.

Assessing Preschoolers- Purposes, Questions and Tools (3-5)

Michaelene Ostrosky, Ph.D., Associate Professor, Department of Special Education, University of Illinois, Urbana-Champaign

This introductory session on assessment will focus on preschoolers with and without disabilities. Participants will learn about the purposes of assessment, different questions to be addressed depending on the purpose (e.g., screening, eligibility, assessment for intervention planning) and appropriate tools.

Embedding Literacy and Language Into Current Curriculum (3-5)

Robert Rockwell, Ph.D., Professor Emeritus

Debra Reichert Hoge, Ed.D., Professor, and Bill Searcy, Ph.D., Department of Special Education and Communication Disorders, Southern Illinois University, Edwardsville

Practical, clear activities, that can be utilized in the classroom or in the home environment to promote both literacy and language development will be shared with participants. Innovative activities will be presented in addition to traditional activities with a new language and literacy focus. Discussion and hands-on demonstration will be highlighted.

UCP Chicago's First Tech Touch (Birth-5)

Pamela E. Ross, Director,

Assistive Technology Exchange Network (ATEN)

UCP Chicago's First Tech Touch Program introduces technology to young children (9 months and older) of all abilities, their parents, and service providers. Participants will gain a greater awareness of available software, keyboards, and input devices and how they can be used creatively in Early Childhood programs. This session is appropriate for beginning and experienced computer users.

Thinking Systemically, Acting Inclusively (Birth-5)

Christine Salisbury, Ph.D., Professor of Special Education and Director Elizabeth Delaney, Ed.D., Assistant Professor of Special Education and Associate Director, UIC Child and Family Development Center

This session will provide participants with an outcome referenced framework for improving services and supports to young children with and without disabilities in early childhood, early intervention settings. DEC Recommended Practices will be used as a point of reference. Examples will be used to illustrate key process and content points. Attendees will have an opportunity to work in groups and apply the information to their local contexts.

Collect, Select, and Reflect: Adapting Practices and Materials to Honor the Diversity of Children and Families (Birth-8)

Amy Santos, Ph.D., Assistant Professor; Rob Corso, Ph.D., Visiting Assistant Professor, Department of Special Education, University of Illinois, Urbana-Champaign

During the last five years the Early Childhood Research Institute on Culturally and Linguistically Appropriate Services (CLAS) has collected over 4,000 early childhood materials. They have reviewed over 400 sets of materials using the CLAS Review Guidelines, which considers (a) the overall effectiveness of presentation; (b) the degree to which materials address the impact of cultural and linguistic diversity; and (c) the effectiveness of materials that have been translated from one language to another. This session describes practices to identify and review materials and practices for their cultural and linguistic relevance. A framework is provided for personnel to use to enhance the cultural and linguistic appropriateness of services for young children with disabilities and their families.



Workshops•Thursday•October 11

Overview of the Work Sampling System (3-5)

Pam Scranton, Teacher, Discovery Preschool, Northminster Learning Center

Participants will become familiar with the three components of the Work Sampling System and how they correspond to the new ISBE Early Learning Standards. Through examination of students' portfolios and WSS materials, the audience will gain knowledge of the application of this assessment tool. Timely tips will also be shared!

It's Okay to Play, Because Play is the Way! (Birth-3)

Connie Shugart, Early Childhood Resource Specialist; Mary Smith, Family Resource Specialist; Joan Leff, Early Childhood Resource Specialist, StarNet Regions I and III

Because of what we know about how children learn and grow, play provides the framework for supporting not only the integration of all areas of development but also supports children as life long learners. Understanding how adults and the environment influence children's learning is crucial. Join us as we focus on the value and benefits of play as well as adaptations to meet the needs of individual children.

Using Developmental Observation Topics to Enhance Parents' Understanding of Their Children's Development (Birth-3)

Tweety Yates, Ph.D., Assistant Research Professor, Department of Special Education, University of Illinois, Urbana-Champaign

This session will present a structure for conveying developmental information to parents in a way that supports their understanding of their child's development and learning. Ideas and examples for translating developmental information into developmental observation topics and ways to structure parents' observations of their children around these topics will be shared.

WORKSHOP SESSION IV • THURSDAY PM • 3:15 PM – 4:45 PM

Move Over Photocopier, Scissors and Glue (3-8)

Support Staff, Center for Best Practices in Early Childhood Education

Participants will gain experience using digital cameras, video cameras, scanners, color printers, and software to create and produce materials that will enhance existing curriculum. In small groups, participants will share

ideas and develop usable products with assistance from session leaders.

Seizure Disorders & Children: Diagnosis, New Treatments and the Family Perspective (Birth-8)

Philip M. Gattone, MEd., Director of Education, Rush-Presbyterian- St. Luke's Medical Center/Rush Epilepsy Center

This presentation is designed to assist educators, administrators, parents, therapists, and others involved in the lives of children with seizure disorders. After attending this presentation, participants will have a greater understanding of various seizure types, proper first aid for seizures, the latest medical treatment options for families, strate-

gies for helping children achieve in the classroom, and a perspective on epilepsy from the viewpoint of parents, children, and caregivers.

Storytelling for the Classroom: Techniques for Bringing Storytelling into the Classroom Everyday (Birth-8)

Linda Gorham, Storyteller

Everyone learns differently. For educators, it is important to utilize several teaching methods to motivate, involve and inspire young people. Storytelling is one approach. It is the art of verbally, physically and imaginatively revealing a story to an audience. The oral tradition of storytelling can open the mind to many new topics, themes, and cultural experiences. Since students learn differently, storytelling can make an impact on them that other mediums may not. Storytelling awakens the auditory, visual, affective and kinesthetic modes of learning.

America's Playgrounds: Make Them Safe, Accessible, and Developmentally Appropriate into the 21st Century (Birth-8)

Sara Kreiss, MA, Design Consultant for Grounds for Play and Adjunct Professor for Triton College

This workshop addresses the new federal law mandating playgrounds meet ADA standards and the many facets of playground development: design that meets your unique program goals, review of the manufacturing industry, child development needs, state licensing regulations and NAEYC criteria. Bring photographs, a site map and anything else that shows elements of your playground area. Every workshop attendee will receive a playground design.

Our Journey With the Reggio Emilia Process (Birth-5)

Sue Martin, Childcare Director; and Nicole Sisney, Art Studio Director, Easter Seals Children's Development, Rockford

This presentation is for educators who are considering bringing the Reggio Emilia process to their sites. Presenters will provide videotapes, written, and visual documentation of the process including transformation of the center and classrooms appearance; the Art Studio; looping from a teacher and parent perspective; how, when and what to document; and parent involvement in the Reggio approach. Participants will see one center's process of implementing the Reggio Emilia philosophy in a childcare setting.

Special Education Rules: Answers and Questions (Birth-8)

Vaughn Morrison, MS Ed MSW, Consultant

Recent changes in special education regulations will be discussed and audience questions will be answered. The main objective is for participants to feel more comfortable undertaking the special education maze.

How to Slow Down and Be Focused in a Harried World (Birth-8)

Linda Murphy Boston, Founder and current Director of St. John's Hospital Center for Mind-Body Medicine

If you feel like you have too many things to do, never enough time to do them and you are beginning to think this harried pace is effecting your health, then you are probably right and this workshop is just what the physician ordered. Drawing from current research in the field of mind-body medicine, facilitator Linda Murphy Boston guides participants through several anchoring techniques to focus the mind and relax the body. Emphasis is on helping people learn easy-to-integrate strategies that help them stay focused and make choices that allow for an internal sense of control.



Workshops•Friday•October 11

Science for Preschoolers (3-5)

Terry Piper, Lakeshore Learning Materials

This session will include a number of activities in the five senses. Air, water, and magnets are used to show teachers that science can be fun and not intimidating. This presentation is targeted to preschool teachers at any level of experience.

Self-Regulation: A Sensory Approach to Helping Children Relate to Their Environment (Birth-8)

Jennifer Rosinia, MEd., OTR/L, KidsLinks Unlimited, Inc.

Children have their own unique way of taking in and responding to the sights, sounds, smells, tastes, feelings, and movements that make up their environments. Each environment is equally unique in regards to the schedules, transitions, and changes in routines that children need to cope with on a daily basis. The ways in which young children process sensory information will be reviewed. Sensory modulation profiles in terms of Arousal, Attention, Affect, and Action in order to understand regulatory disorders will be examined and individualized intervention strategies will be highlighted.

SOS – Support Our Siblings (Birth-8)

Mary Smith, Family Resource Specialist

Roseann Slaght, Family Resource Specialist, StarNet Regions I and III
Siblings have the unique distinction of having the longest lasting family relationship. Parents and providers must be aware that siblings of children with disabilities need as much, if not more, support as parents. This presentation will focus on the presenters' experience and sharing of ideas and recommendations to support siblings so that their journey in life is happy and supported as a valued family member.

Work It Out – Resolving Conflicts Peaceably (Birth-8)

*Topper Steinman, MA., Counselor and Consultant
Champaign, Illinois*

This session will focus on six abilities and a communication process that adults and children can use to peaceably work through the tough stuff of life. The session will be interactive and applicable to adults and children.

Interagency Agreements: Top Ten Do's and Don'ts of Effective Partnerships (Birth-5)

*Jill Tompkins, BA, Infant/Toddler Specialist,
Amanda Quesenberry, BA, Program Support Specialist
Great Lakes Quality Improvement Center for Disabilities*

This session will present tips for agencies to consider when partnering within the community. Using the "Late Show" Top Ten List, management, administrative, and childcare staff will gain an understanding of the process of developing partnerships and the content of effective interagency agreements.

Friday • October 12

WORKSHOP SESSION I • FRIDAY AM • 10:45 AM – 12:15 PM

They Got the Main Idea . . . But Missed the Meaning: Exploring New Developments in Reading Comprehension (5-8)

Kathy Barclay, Ph.D., Chair, Department of Curriculum and Instruction, Western Illinois University, Macomb

Research in reading comprehension has revealed key strategies used by active, thoughtful, readers to understand what they read. In this session, participants will explore ways to teach children strategies for making connections, questioning, inferencing, summarizing and synthesizing.

New Leaps, Less Boundaries . . . How to Unleash Your Creativity (Birth-8)

Denis Berkson, aka the Creative Crusader, WORDPlay & Associates
Denis Berkson, aka the Creative Crusader, explores the key elements of his program, Creative Jolts 101. Get ready to shake loose old mindsets and rattle creative cobwebs. A fast paced, experiential breakthrough for generating ideas, testing hunches, and trusting instincts. Individual and group exercises will take participants from personal exploration to group experimentation—from playing with strange connections, to the discovery of exciting points of view.

Home Visiting Is More Than Going To The Home (Birth-5)

Patricia Brady, Ph.D., Family Advocate

This presentation addresses strategies that are helpful in enhancing the effectiveness of home visitors. Focusing on understanding the culture and context of the community that families live in, participants will engage in an exercise to apply home visiting principles.

Shorter Than A Snooze: Quick and Effective Staff Development Ideas (Birth-8)

*Camille Catlett, MA., Frank Porter Graham Child Development Center, University of North Carolina, Chapel Hill, NC
Debra Reichert Hoge, Ed.D., Professor, Department of Special Education and Communication Disorders, Southern Illinois University, Edwardsville*

Supporting the development of a capable and confident workforce to serve young children and families requires ongoing effort. This presentation will share ideas for videos, activities, games and other fun and engaging ways to enhance the skills of early care and educational personnel. Areas of emphasis will include speech and language development, early brain development, cultural and linguistic diversity, inclusion, and environments. A generous handout set will give participants many examples to take away and try in their programs and communities.

A Panel Discussion: Blending Pre-Kindergarten At-Risk and Early Childhood Special Education (3-8)

Sharon Doubet, MS.Ed., Moderator, StarNet Regions I and III

Serving children who have qualified for Pre-K and ECSE together in the same classroom occurs after much investigation and input from all involved. This presentation will address the following topics: decision making process, teaming, planning, implementing curriculum/assessment, and financial issues. Panel members from blended programs will share their challenges, successes, headaches and joys!



Workshops•Friday•October 11

The Transition from Part C to Part B Services: What Do We Need To Know? (Birth-5)

Lisa Fisher, Resource Specialist, and Pat Kluzik Stauch, Parent Resource Specialist, StarNet Region II

Through this interactive workshop, participants will understand the differences and similarities of Part C (Early Intervention) and Part B (3-21) of the Individuals with Disabilities Education Act (IDEA '97). Information about Illinois Special Education Rules, school district, and early intervention responsibilities related to transition will be shared. Ideas on transition from parent, early intervention, and school district perspectives will be explored.

Seizure Disorders & Children: Diagnosis, New Treatments and the Family Perspective (Birth-8) — Repeat Session

Philip M. Gattone, MEd., Director of Education

Rush-Presbyterian- St. Luke's Medical Center/Rush Epilepsy Center
This presentation is designed to assist educators, administrators, parents, therapists, and others involved in the lives of children with seizure disorders. After attending this presentation, participants will have a greater understanding of various seizure types, proper first aid for seizures, the latest medical treatment options for families, strategies for helping children achieve in the classroom, and a perspective on epilepsy from the viewpoint of parents, children, and caregivers.

Focused Portfolios: An Efficient Assessment to Use with Infants, Toddlers and Preschoolers (Birth-5)

Gaye Gronlund, MA, ECE Consulting, Inc.

Focused Portfolios: A Complete Assessment of the Young is a new, authentic assessment system designed to help teachers of children birth to five. Sharpening observation skills, taking good quality photographs, and relating portfolio materials to developmental standards will be the core of the discussions and materials shared.

A Vision of Caring Schools (Birth-8)

Ken Hinton, MA, Assistant Superintendent for Community Programs, Peoria School District #150.

Linda Lyman, Ph.D., Associate Professor, Department of Educational Administration and Foundations, Illinois State University

Having a vision of a caring school makes a difference to teaching and leading. A caring school enhances student learning and parent involvement. Through exposure to ideas from "How Do They Know You Care?" participants will better understand the benefits of caring and the components involved in creating a caring learning environment.

Critical Thinking Through Project Work in Early Childhood Settings (Birth-5)

*Marjorie Klein, Head Teacher, and Jolyn Blank, Head Teacher
University Primary School, University of Illinois,
Urbana-Champaign*

Children engaged in project investigations develop critical thinking skills. Come and see how teachers using project work probe students' thinking through investigation, observation, prediction, discussion, representation, and display. Examples which illustrate the value placed on children's ideas, questions, and thought processes, and the role they play in learning will be shared.

Everybody Can Dance and Every Body Can Dance! (Birth-8)

Roberta (Bobbi) A. Lucas, MA, Wolf Trap, Institute for Early Learning Through the Arts, Vienna, Virginia

Taking a cue from "The Queen Who Couldn't B-B-B-B-Boogie!" this session is designed as an engaging workshop for those who want to incorporate movement and dance activities into their work with young children. Creative movement activities enhance gross motor development, language acquisition, cooperative learning skills, and dramatic play while focusing on developing children's self-esteem and creative expression. Recorded music, whistles, rhythm instruments and simple props made from scarves, fabric and elastic enable teachers and children to "dance" stories, themes and lessons that are appropriate for "every body" at whatever age or ability level.

Developmental Continuity in Early Childhood: Vicissitudes & Victories (Birth-8)

Susan W. Nall, Ph.D., Professor and Director of Early Childhood Education, Southern Illinois University, Edwardsville

How is the Early Childhood Profession addressing continuity? How are we collaborating from birth through the primary grades? How are we incorporating the Illinois Learning Standards into our programs and articulating the curriculum vertically and horizontally? Continuity is the heart of the early childhood profession as it moves forward in the 21st century. Hear about the vicissitudes & victories from several districts.

Not Quite Right: Understanding Disorders of Regulation (Birth-5)

Jennifer Rosinia, MEd., OTR/L, KidsLinks Unlimited, Inc.

Most children develop internal control or regulation within the first few months of life. If a child has not yet mastered the ability to self calm, has difficulty with sleeping, is intolerant to change, and appears to be in a hyperalert state then the child may have a regulatory disorder. In this workshop, regulatory disorder will be defined and outcomes of such disorders on later development will be discussed and assessment and treatment of regulatory disorders in young children will be highlighted.

UCP Chicago's First Tech Touch — Repeat Session (Birth-5)

Pamela E. Ross, Director,

Assistive Technology Exchange Network (ATEN)

UCP Chicago's First Tech Touch Program introduces technology to young children (9 months and older) of all abilities, their parents, and service providers. Participants will gain a greater awareness of available software, keyboards, and input devices and how they can be used creatively in Early Childhood programs. This session is appropriate for beginning and experienced computer users.

Bringing Books Alive (3-5)

Jodi Scott, Regional Office of Education, Monmouth

Jodie Grinstead, Pre-kindergarten Teacher, Union Elementary School

During this lively interactive session, session leaders will share classic and new literature along with innovative ideas to help children get excited about books. Presenters will demonstrate many styles and ways books and stories can be shared in the early childhood classroom as well as how they can become topics for project learning.

Workshops•Friday•October 11

Building a Transdisciplinary Team (3-5)

Catherine Stanton, Early Childhood Education Teacher

Kimberly Miller, Speech/Language Pathologist

Linda Brannigan, Physical Therapy Assistant

Rosemarie Arakelian, Occupational Therapist Assistant

This session will focus on the process of developing a special education service model that incorporates the support services of speech, occupational and physical therapy within the natural context of the early childhood classroom. The team consists of an early childhood education teacher, a speech/language pathologist, an occupational therapist and a physical therapist from Cook County School District #130, which is a demographically diverse school district in the southern suburbs of Chicago. The team will describe the successes and challenges of their experience, which began seven years ago with a vision of incorporating a transdisciplinary model in their school.

The Most Awesome Professional Development . . . National Board Teacher Certification (3-8)

Cheri Stewart, Teacher; Char Knudten, Teacher;

Lee County Special Education Association

This session will introduce participants to the National Board for Professional Teaching Standards (NBPTS) certification process. Participants will receive information about certification areas, national teaching standards, portfolio requirements, assessment center expectations, and the application process in Illinois.

Autism 101 (Birth-8)

Sandy Valentine, Resource Specialist, StarNet Regions I and III

Anyone working with young children with autism and their families will benefit from attending this workshop. Participants will learn to understand the young child diagnosed with autistic spectrum disorder. The session focuses on strategies to help the child with autism be successful at home and in the classroom, with the use of simple, inexpensive learning materials. Resources will be offered.

WORKSHOP SESSION II • FRIDAY PM • 1:30 PM – 3:00 PM

The Effects of Incarceration on Family and Community (Birth-8)

Joanne Archibald, BA, Advocacy Project Director

Chicago Legal Advocacy for Incarcerated Mothers (CLAIM)

The increasing use of incarceration as a response to social problems such as addiction, poverty, and lack of education has affected millions of children. This workshop will provide information about the effects of parental incarceration on young children and discuss strategies for helping children whose lives are disrupted by the arrest or incarceration of a parent.

The Social and Emotional Environment in Early Childhood Settings (Birth-5)

Eileen T. Borgia, Ph.D., Assistant Professor,

Early Childhood Education, Illinois State University, Normal

Carol Weisheit, MA., Executive Director,

Illinois Coalition Against Sexual Assault

Participants will analyze features in early childhood environments that promote social and emotional development and competence. Topics will include an overview of research indicating that environmental features such as adult-child and child-child interactions, ambiance, timing

and pacing, and attachment and separation have a significant influence on the emotional health of young children.

Embedding Assessment into the Regular Routines of an Inclusive Environment (3-5)

Rebecca J. Cook, Ph.D., Associate Professor, Eastern Illinois University

This session will focus on a naturalistic assessment process involving the reorganization of items on a criterion reference tool so assessment can be conducted during routines of the day and through fun, game-oriented activities. Participants will learn how to reorganize assessment tools according to their schedules and the presenter will demonstrate assessment activities.

Beyond the Easel and Brush (Birth-5)

Ann Curtis, MA, Teacher/Director

Western Illinois University Infant & Preschool

This workshop will review the four stages of evolving children's art which will lead into a discussion of the importance of open ended, process oriented art projects as well as skills children learn through art experiences. The presenter will share examples of art projects that have been enjoyed at the WIU center. How children's literature can be a stepping stone for many art experiences will be discussed and examples of class made bulletin boards relating to specific poems or stories will be shared.

Inclusion: Best Practices (3-8)

Charlotte Denight, BS, Consultant/Trainer

H.E.A.R. – Highlighting Education and Resources

Barbara Fiedler, Ed.D. Assistant Professor of Special Education

Illinois State University

This session is designed to address various concerns regarding the inclusion of students who are deaf or hard of hearing. The main focus is on ways to adapt the environment including barriers and solutions for inclusion, critical supports and resources related to inclusion, legal considerations, and parent participation. Assistive technology used in the home and in the classroom will be on display.

Frazzled Francine & Stressed Out Stefan (Birth-8)

Elizabeth Frisbie, MA, M.Ed., EC Consultant/Behavior Specialist

Education for Change

Divorcing parents, illness, abuse, no friends . . . Are students under a lot of stress? This session will identify the warning signs of stress overload in children and show teachers how they may help students reduce stress levels and relax. The impact of chronic stress on brain, cognitive and social-emotional development will also be discussed as will instructional modifications and behavior management techniques recommended for stressed children.



Workshops•Friday•October 11

How to Grow a Strong Child: “Wrap” Them While They’re Young! (3-8)

*Vernessa Gipson, MSW, Regional Coordinator, ISBE EBD Network
Cassandra Baker, Director, FANS (Families Accessing Networks and Support), East Central Chapter-Federation of Families for Children’s Mental Health*

Many children with emotional and behavioral disabilities, both diagnosed and suspected, and their families frequently have unmet needs that are across many life domains. This workshop is designed to provide participants with a general understanding of the Wraparound philosophy and process that can be used in assisting families in identifying their strengths, their needs and appropriate resources. The Wraparound process is based on individualized, needs driven planning and services. It is not a program or a type of service. It is a value base and an unconditional commitment to create services on a “one kid at a time” basis to support normalized and inclusive options for students with complex needs and their families.

Reading, Rainsticks, and Recipes (3-8)

*Anne Golden, BA, Director; Kaylee Johnson, Assistant Director
Bright Futures Resource Center*

Play is a child’s work. It is our role as parents and educators to provide materials and an environment that can stimulate creative thinking. Participants will have an opportunity to create sample books, toys, and musical instruments that can be used by children ages 3-8 in their play, and by the adults who work with them. Try some recipes and take away samples and experiences from the session to share with your children and staff.

Augmentative Communication Systems for Young Children with Autism (Birth-8)

*Cheryl Light-Shriner, Ph.D., Department of Special Education
University of Illinois, Urbana-Champaign*

The presentation will include a discussion of beginning communication systems that can be taught to children with autism. Numerous examples of augmentative systems will be demonstrated and examples of children who would use such systems will be discussed.

Ages and Stages Questionnaire (ASQ): Parent Completed Child Monitoring System (Birth-5) Repeat Session

*Lynn R. Liston, Ed.D, Coordinator for Pediatric Specialty Services
Rockford Memorial Hospital*

This workshop will present general information about screening and assessment, including the components of a screening program, factors

to consider when reviewing screening information, the requirements of IDEA, and how the use of the ASQ can enhance Child Find efforts.

Information regarding the rationale behind the development of the ASQ system, the accuracy of parent report, and cultural sensitivity and flexibility of the tool will be presented. Participants will practice scoring and view a video illustrating the use of the ASQ in a home.

Everybody Can Dance and Every Body Can Dance! (Birth-8) Repeat Session

*Roberta (Bobbi) A. Lucas, MA, Wolf Trap,
Institute for Early Learning Through the Arts, Vienna, Virginia*
Taking a cue from “The Queen Who Couldn’t B-B-B-B-Boogie!” this session is designed as an engaging workshop for those who want to incorporate movement and dance activities into their work with young children. Creative movement activities enhance gross motor development, language acquisition, cooperative learning skills, and dramatic play while focusing on developing children’s self-esteem and creative expression. Recorded music, whistles, rhythm instruments and simple props made from scarves, fabric and elastic enable teachers and children to “dance” stories, themes and lessons that are appropriate for “every body” at whatever age or ability level.

The Best of Play: Matching What We Do With What We Know (3-8)

*Jean Maakestad-Wolf, Associate Professor, Early Childhood
Education, Western Illinois University*

As teachers, we’ve experienced the joy children express when they lose themselves in play and their disappointment when they must stop playing. We will examine how play in the classroom can help teachers meet classroom goals and identify strategies to connect children’s play with these goals.

Coping with Functional Vision Problems in the Learning Environment (Birth-8)

*Phyllis Maciulis, SSW, LCSW
Susan Kuranishi, Developmental Therapist
The Chicago Lighthouse for People Who Are Blind
or Visually Impaired*

During this workshop, participants will explore the wide range of visual problems and learn techniques to make the most of their student’s sensory potential. The presenters will share case examples from their experience in identifying, adapting to and overcoming visual deficit.

Our Journey With the Reggio Emilia Process (Birth-5)

Repeat Session

*Sue Martin, Childcare Director
Nicole Sisney, Art Studio Director
Easter Seals Children’s Development, Rockford*

This presentation is for educators who are considering bringing the Reggio Emilia process to their sites. Presenters will provide videotapes, written, and visual documentation of the process including transformation of the center and classrooms appearance; the Art Studio; looping from a teacher and parent perspective; how, when and what to document; and parent involvement in the Reggio approach. Participants will see one center’s process of implementing the Reggio Emilia philosophy in a childcare setting.



Workshops•Friday•October 11

There's More To Math Than 1,2,3 (3-8)

Sherial McKinney, Ms.Ed.

This workshop will offer mathematical skills and activities beyond counting and number identification. Ideas and materials presented will include vocabulary, literature and hands-on activities. National standards, Illinois Early Learning Standards, and state initiatives will be addressed.

Music Therapy in Early Intervention and Early Childhood (Birth-8)

*Jennifer Swan Merth, MT-BC, Owner/Director
Illinois Music Therapy Services (IMTS)*

This workshop will be a hands-on exploration of using music with children. It will be geared towards teachers, aides, parents, therapists, or anyone interested in using music with children. Participants will learn what music therapy is and how music facilitates children's development in the areas of cognitive skills, communication skills, motor skills, and social skills.

Special Education Rules: Answers and Questions (0-8) Repeat Session

Vaughn Morrison, MS Ed MSW, Consultant

Recent changes in special education regulations will be discussed and audience questions will be answered. The main objective is for participants to feel more comfortable undertaking the special education maze.

Discovery Science-The Family Connection (3-5)

*Robert Rockwell, Ph.D., Professor Emeritus
Southern Illinois University, Edwardsville*

The purpose of this hands-on session is to reinforce the importance of using science as a natural avenue for children, families and teachers to work together. Rationale, strategies, and activities for teachers and parents will be shared.

Turning a "Me Thing" into a "We Thing": Teen Mothers, Fathers, and Their Infants (Birth-3)

*Nick Wechsler, MA, Birth-3 Program Manager
The Ounce of Prevention Fund*

Adolescence can be described as a "me thing." Our work with adolescent parents, from pregnancy through the earliest years, is to turn a "me thing" into a "we thing." This presentation will illustrate a methodology for engaging pregnant teens in an array of meaningful and enjoyable activities which help them develop an attuned engagement with their infants. The workshop introduces the Community Based Family Administered Neonatal Activities, an intervention design for use with adolescent parents throughout the perinatal period. The presentation will include discussion, interactive demonstrations, and video tapes of program participants. This program promotes secure attachment and successful growth and development for infants and their parents.

Exhibitors

Don't miss seeing new materials and products on display in the Exhibition Area.

EXHIBIT HOURS:

Wednesday, October 10

4:00 pm – 7:00 pm

Thursday, October 11

7:30 am – 4:30 pm

Friday, October 12

7:30 am – 1:30 pm

A+ IMAGES, INC.

3110 Sunrise, Crown Pointe, IN 46307
800/634-0054

APPLE LANE PRODUCTIONS

921 Black River Rd., Bangor, MI 49013
616/427-6064

C & D SILKSCREENING

100 Crossroad Dr., Ste. E, Whiteland, IN 46184
317/535-1003

CHARACTER BUILDING COMPANY

147 Boskydells, Collinsville, IL 62234
618/345-79567

CHILDCRAFT EDUCATION CORPORATION

400 East 33rd St. Chicago, IL 60616
312/225-7516

CLAS EARLY CHILDHOOD RESEARCH INSTITUTE

61 Children's Research Center, 51 Gerty Dr.,
Champaign, IL 61820
217/244-3105

DELTA EDUCATION

125 Cinderford Dr., Oswego, IL 60543
630/215-3017

DISCOVERY TOYS

2941 Old Freeburg Rd., Belleville, IL 62220
618/233-9519

DIVISION OF SPECIALIZED CARE FOR CHILDREN

2815 W. Washington, Ste. 300,
Springfield, IL 62794
217/793-2350

EXPERIENCES!

P.O. Box 5391,
Bloomington, IL 61702
309/454-3831

GROUNDS FOR PLAY

327 N. Rigeland, Oak Park, IL 60302
708/848-8737

HARRISON AND COMPANY

970 N. Oak Lawn Ave., Elmhurst, IL 60126
630/782-6077

ILLINOIS DEPARTMENT OF PUBLIC AID

525 W. Jefferson, Springfield, IL 62707
217/557-0005

ILLINOIS STARNET

6020 W. 151st Street, Oak Forest, IL 60452
708/342-5370

INNOVATIVE EDUCATORS ENTERPRISES, INC.

P. O. Box 520, Montezuma, GA 31063
888/252-5437

JASON & NORDIC PUBLISHERS

424 N. Montgomery Street,
Hollidaysburg, PA 16648
814/696-2929

Exhibitors continued ...

KAPLAN COMPANIES

1310 Lewisville-Clemmons Road,
Lewisville, NC 27023-0609
800/334-2014

KAREN'S KIDS

P. O. Box 408, Ft. Madison, IA 52627
319/376-5959

KIDCARE

201 S. Grand Avenue East,
Springfield, IL 62763-0001
217/524-7132

LEARNING SHOP

6368 B East 82nd Street, Indianapolis, IN
46250
317/842-1723

M. S. CREATIONS

Box 83, Boliva, MO 65613
417/326-7736

OFFICE OF THE ILLINOIS ATTORNEY GENERAL

500 South Second St.,
Springfield, IL 62706
217/524-8832

PRESENTATIONS DIRECT

6351 South 6th Street, Springfield, IL 62708
217/529-2463

SCHOOL MATE INCORPORATED

P. O. Box 2225, Jackson, TN 38302
731/935-2000

STOEITING COMPANY

620 Wheat Lane, Wood Dale, IL 60191
630/860-9700

THE 3 R'S LEARNING MATERIALS CENTER

320 North Alpine Rd., Ste. 300,
Rockford, IL 61107
815/398-1600

THE PSYCHOLOGICAL CORPORATION

19500 Bulverde Road, San Antonio, TX 78259
210/339-5246

UNITED LEARNING

1560 Sherman Avenue, Ste. 100,
Evanston, IL 60201
847/328-6700

Call for Nominations

Jeanette A. McCollum Award for Service to the Field Illinois Division for Early Childhood (DEC)

You are invited to submit the name of an individual for the Jeanette A. McCollum award for Service to the Field. This award is given to an individual who meets the high standards of professional practice set by Jeanette A. McCollum. Jeanette is a leader in research and personnel preparation in the field of early intervention/early childhood special education, professor emeritus at the University of Illinois in Urbana-Champaign, and has contributed significantly within Illinois and to the International Division for Early Childhood (DEC). Candidates for the Jeanette A. McCollum Award shall meet the following criteria:

1. Be a professional in an agency or an organization in the field of early intervention/early childhood (0-8), family member, student or community member or an area that directly impacts on early intervention/early childhood (e.g., government);
2. It is encouraged, but not required, that the candidate be a current member of DEC;
3. Have made significant contributions on a state, regional, or local level that have improved or will improve the lives of young chil-

dren with special needs, their families, or those who work on their behalf. Contributions may be in direct services, personnel preparation, leadership, policy development, research, advocacy, or publications and are supportive of the goals of Illinois and International DEC).

An award recipient shall receive a plaque or other commemorative award (trophy, statue, etc.), cash award, have her/his registration to the Sharing A Vision (SAV) conference waived, one-year complimentary membership into DEC/CEC, and have details of their award published in the Illinois DEC newsletter. Please send nominations (letter of support outlining the three criteria above and any additional supporting documentation) to Susan Maude (46 Lookout Trace, Galena, IL 61036, smaude@loras.edu) by May 1, 2003. The outcome of this review process will be determined by August 15, 2003. Should you have any questions or concerns please contact Susan at the contact information listed above. Make sure to attend the opening session where we will recognize this years' recipient of the Jeanette A. McCollum award.

Please complete your evaluations. It is the best way to make Sharing A Vision better! Evaluation is one of the most important components of the Sharing A Vision Conference. Following the conference, the planning committee thoughtfully addresses the many suggestions and concerns expressed by attendees. Many elements of this year's conference reflect changes suggested by participants in prior conferences. Deposit your evaluation at the Evaluation Table near the Registration Area and receive your surprise.

REMEMBER — WE WANT TO HEAR FROM YOU!

Job Placement ...

Are You Looking for a New Job? Or Looking to Fill a Vacancy?

The Sharing a Vision Job Opportunities Bulletin Board is just the thing for you!!! It's easy. Just visit the Job Opportunities bulletin board on the Plaza Level. Employers and prospective employees have shared information. Check the bulletin board daily during the conference and be sure to inform the potential employer about how you found out about the vacancy.

Visit the Exhibit Hall and Conference Store for afternoon snacks.

Join IDEC

The Division for Early Childhood (DEC) of the Council for Exceptional Children (CEC) is a nonprofit organization advocating for individuals who work with or on behalf of children with special needs, birth through age eight, and their families. Founded in 1973, the Division is dedicated to promoting policies and practices that support families and enhance the optimal development of children. Children with special needs include those who have disabilities, developmental delays, are gifted or talented, and are at risk of future developmental problems.

For more information and a membership application to join IDEC, contact:

Donna Nylander (DONNA_NYLANDER@IPSD.ORG)

Indian Prairie District 204 • P.O. Box 3990 • Naperville, IL 60567
or Tweety Yates (T-FELNER@UIUC.EDU), University of Illinois at Urbana-Champaign
61 Children's Research Center • 51 Gerty Drive • Champaign, IL 61820



Springfield Visitor's Information

It has been said that a young politician named Abraham Lincoln was so fond of meeting in Springfield, that in 1837 he did some political maneuvering to help make it the State Capital. From that point on, the city's history, and indeed its future, has been and will always be inexorably tied to this famous American. Springfield is a unique community, where hotels are neighbors to historic sites and legislators rub elbows with lobbyists. We hope SAV participants will find time to take advantage of a few of the many historical and cultural opportunities offered in Springfield, "the city Lincoln loved." For more information or a Family Vacation Planning Kit, contact the Springfield Convention and Visitors' Bureau at 800/545-7300 or www.springfield.il.us/visit.

Presenter's Information

Anderson, Sharon
Prairie Children Preschool
Indian Prairie School Dist. 204
P. O. Box 3990
Naperville, IL 60567

Arakelian, Rosemarie
Horace Mann School
2975 West Broadway
Blue Island, IL 60406

Archibald, Joanne
Chicago Legal Advocacy for
Incarcerated Mothers
205 W. Randolph, Ste. 830
Chicago, IL 60606

Baker, Cassandra
Families Accessing Networks &
Support
East Center Chapter-FFCMH
P.O. Box 321
Champaign, IL 61824

Barclay, Kathy
1131 Stacy Lane
Macomb, IL 61455

Beneke, Sallee
Illinois Valley Community College
106 Park Avenue East
Princeton, IL 61356

Benelli, Cecelia
Western Illinois University
1 University Circle
Macomb, IL 61455

Bennett, Tess
Great Lakes QIC-D
U of I Children's Research Ctr./51
Gerty Dr.
Champaign, IL 61820

Berkson, Denis
WORDPlay & Associates
2016 Woodview Drive
Mt. Prospect, IL 60056

Black, Laura
139 Twin Oaks
Chatham, IL 62629

Blank, Jolyn
University Primary School
Children's Research Center
51 Gerty Drive
Champaign, IL 61820

Borgia, Eileen
Illinois State University
600 Normal Avenue
Normal, IL 61761

Brady, Patricia
5329 S. Dorchester, Apt. 1A
Chicago, IL 60615

Brannigan, Linda
Horace Mann School
2975 West Broadway
Blue Island, IL 60406

Catlett, Camille
Frank Porter Graham Child
Development Center
University of North Carolina CB 8185
Chapel Hill, NC 27599

Carlson, Cristin
Prairie Children Preschool
Indian Prairie School Dist. 204
P. O. Box 3990
Naperville, IL 60567

Champagne, Ruth
Concordia University
7400 Augusta St.
River Forest, IL 60305

Chandler, Lynette
Dept. of Teaching & Learning
Northern Illinois University
DeKalb, IL 60115

Clark, Letha
Center for Best Practices in EC
Education
27 Horrabin Hall/WIU
Macomb, IL 61455

Cook, Rebecca
Eastern Illinois University
710 Lakeshore Dr.
Tuscola, IL 61920

Corso, Rob
CLAS Institute
61 Children's Research Center
51 Gerty Drive
Champaign, IL 61820

Coughlin, Mary
A.E.R.O.
7600 S. Mason Ave.
Burbank, IL 60459

Crafton, Kiersten
Prairie Children Preschool
Indian Prairie School Dist. 204
P. O. Box 3990
Naperville, IL 60567

Crampton-Fahrenkrog, Darlene
Concordia University
7400 Augusta St.
River Forest, IL 60305

Curtis, Ann
WIU Infant and Preschool Center
Horrabin Hall, Rm. 12
Macomb, IL 61455

Delaney, Elizabeth
College of Education (MC 147)
1040 West Harrison St.
Chicago, IL 60607

DeLuna, Eva
400 Iles Park Place, 1st Floor
Springfield, IL 62762

Denight, Charlotte
H.E.A.R.
125 Webster Ave.
Jacksonville, IL 62650

Doubet, Sharon
StarNet Regions I and III
27 Horrabin Hall/WIU
Macomb, IL 61455

Draper, Kim
Hillsboro CUD #3
Early Childhood Program
279 Barry-Hope Trail
Hillsboro, IL 62049

Ellinor, Kathy
3119 W. Stephenson St.
Freeport, IL 61032

Fabian, Claudia
400 Iles Park Place, 1st Floor
Springfield, IL 62762

Fiedler, Barbara
Illinois State University
Department of Special Education
Normal, IL 61701

Fisher, Lisa
StarNet Region II
1855 Mt. Prospect
Des Plaines, IL 60018

Fowler, Susan
SPARK
U of I Education Bldg, Rm. 38E
1310 S. 6th St.
Champaign, IL 61820

Frisbie, Elizabeth
Education for Change
6329 High St.
Moro, IL 62067

Gage, Lynette
1334 Pepperidge Dr.
O'Fallon, IL 62269

Gage, Sharon
1334 Pepperidge Dr.
O'Fallon, IL 62269

Gattone, Phil
Rush-Presbyterian-St. Lukes Medical
Center
1653 W. Congress Pkwy., Ste. 334
Murdock
Chicago, IL 60612

Gerriets, Jeanne
Campaign for Better Health Care
44 E. Main St., Ste. 414
Champaign, IL 61820

Gilmore, Gennie
IDHS Head Start Collaboration
10 Collinsville Ave., Ste. 203
East St. Louis, IL 62201

Gipson, Vernessa
ISBE-ITAN Coordinator
DCFS Education Advisor
P.O. Box 321
Champaign, IL 61824

Golarz, Raymond
P. O. Box 7197
Bloomington, IN 47407-7197

Golden, Anne
Bright Futures Resource Center
1072 W. North St.
Galesburg, IL 61401

Gorham, Linda
1009 Chadwick Ct.
Aurora, IL 60504

Gottlieb, Mary Ann
Valeska Hinton Early Childhood
Education Center
5606 S. Lafayette
Peoria, IL 61607

Presenter's Information

Grinstead, Jodi
Union Elementary School
200 W. Broadway
Monmouth, IL 61462

Gronlund, Gaye
ECE Consulting, Inc.
12005 Watermark Ct.
Indianapolis, IN 46236

Handler, Becky
StarNet Region VI
6020 W. 151st St.
Oak Forest, IL 60452

Hanselman, Elizabeth
Illinois State Board of Education
100 N. First St. S-306
Springfield, IL 62777

Hayes, Rhoda
Macomb CUSD #185
MacArthur Early Childhood Center
235 W. Grant
Macomb, IL 61455

Heins, Sandy
216 Florence
Bloomington, IL 61701

Helm, Judy
Best Practices, Inc.
10109 Fox Creek Dr.
Brimfield, IL 61517

Hertzog, Nancy
University of Illinois Dept. of
Education
288 Education Bldg. 1310 S. 6th St.
Champaign, IL 61820

Hinton, Ken
Peoria Public Schools
8100 W. Tuscarora Rd.
Mapleton, IL 61547

Hull, Nancy
Prairie Children Preschool
Indian Prairie School Dist. 204
P. O. Box 3990
Naperville, IL 60567

Jaroz, Jane
Prairie Children Preschool
Indian Prairie School Dist. 204
P. O. Box 3990
Naperville, IL 60567

Johnson, Kaylee
Bright Futures Resource Center
1072 W. North St.
Galesburg, IL 61401

Jorgenson, Catherine
5178 Hutchinson
South Beloit, IL 61087

Justice, Sue
7213 N. Crabapple Court
Peoria, IL 61614

Kirchgessner, Sue
1369 N. Prairie St.
Galesburg, IL 61401

Klein, Marjorie
University Primary School
Children's Research Center
51 Gerty Drive
Champaign, IL 61820

Knudten, Char
Jefferson School
800 4th Avenue
Dixon, IL 61021

Kreiss, Sara
Grounds for Play
7346 W. Lake St.
River Forest, IL 60305

Kuranishi, Susan
The Chicago Lighthouse for People
Who Are Blind or Visually
Impaired
1850 W. Roosevelt
Chicago, IL 60608

Leff, Joan
7619 Nan Dr.
Roscoe, IL 61073

Lehl, Christine
ISBE
19123 Weber Rd. #3
Mokena, IL 60448-1032

Light-Shriner, Cheryl
University of Illinois-Rm. 288 College
of Education
2707 Susan Stone Drive
Urbana, IL 61802

Liston, Lynn
Rockford Memorial Hospital-
Perinatal Center
Dept. of Child Development
2400 N. Rockton Ave.
Rockford, IL 61103

Lucas, Bobbi
Wolftrap
1624 Trap Road
Vienna, VA 22182

Lyman, Linda
Illinois State University
611 W. Stratford Dr.
Peoria, IL 61614

Maakestad-Wolf, Jean
616 Memorial Drive
Macomb, IL 61455

Mace, Jacquie
1105 Chatham Rd.
Bloomington, IL 61704

Maciulis, Phyllis
The Chicago Lighthouse for People
Who Are Blind or Visually
Impaired
1850 W. Roosevelt
Chicago, IL 60608

Martin, Sue
Easter Seals Children's Development
Center
650 N. Main St.
Rockford, IL 61103

McKee, Ronda
Northwestern CUSD #175
Good Hope, IL 61423

McKinney, Sherial
14361 E. 1800th St.
Macomb, IL 61455

McLean, Mary
University of Wisconsin-Milwaukee
Dept. of Exceptional Children-P.O.
Box 413
Milwaukee, IL 53201

Merth, Jennifer
Illinois Music Therapy Services
P. O. Box 102
Princeton, IL 61356

Miller, Kim
Horace Mann School
2975 West Broadway
Blue Island, IL 60406

Morrison, Vaughn
1603 S. Lincoln Ave.
Springfield, IL 62704

Murphy Boston, Linda
Center for Mind-Body Medicine, St.
John's Hospital
800 E. Carpenter
Springfield, IL 62769

Nall, Susan
Early Childhood School of Education
Southern Illinois University
Edwardsville
Edwardsville, IL 62025

Neuber, Keith
1004 E. 5th St. P. O. Box 516
Alton, IL 61853

Niswander, Vicki
Project CHOICES
6S331 Cornwall Rd.
Naperville, IL 60540

Ostrosky, Michaelene
University of Illinois-Dept. of Spec.
Ed.
288 Education Bldg. 1310 S. Sixth St.
Champaign, IL 61820

Patlán, Olivia
400 Iles Park Place, 1st Floor
Springfield, IL 62762

Piper, Terry
Lakeshore Learning Materials
3501 Sunnyside
Brookfield, IL 60513

Pufahl, Nancy
StarNet Region VI
6020 W. 151st St.
Oak Forest, IL 60452

Quesenberry, Amanda
Great Lakes QIC-D
196 CRC, 51 Gerty Dr.
Champaign, IL 61820

Reichert-Hoge, Debra
Southern Illinois University
Edwardsville
Box 1147 SIUE
Edwardsville, IL 62026

Reiniche, Juli
Prairie Children Preschool
Indian Prairie School Dist. 204
P. O. Box 3990
Naperville, IL 60567

Rockwell, Robert
1920 Cedarwood Trail
Belleville, IL 62226

Presenter's Information

Rosinia, Jennifer
KidLinks Unlimited, Inc.
18335 Maple St.
Lansing, IL 60438

Ross, Pam
ATEN
7600 West 183rd St. Willow Hall
Tinley Park, IL 60477

Rothenberg, Dianne
ERIC Clearinghouse
CRC, 51 Gerty Drive
Champaign, IL 61820

Ruther, Gina
IDHS Head Start Collaboration
10 Collinsville Ave., Ste. 203
East St. Louis, IL 62201

Salisbury, Christine
UTC Child & Family Development
Center (MC 628)
1640 W. Roosevelt Rd., Rm. 336
Chicago, IL 60608

Santos, Amy
University of Illinois
288 Education Bldg. 1310 S. Sixth St.
Champaign, IL 61820

Schackmann, Julie
Project CHOICES
6S331 Cornwall Rd.
Naperville, IL 60540

Scott, Jodi
Union Elementary School
220 W. Broadway
Monmouth, IL 61462

Scott, Nancy
Hearing & Visions Connections-ISD
125 Webster
Jacksonville, IL 62650

Scranton, Pam
Discovery Preschool
Northminster Learning Center
Peoria, IL

Searcy, Bill
Southern Illinois University
Edwardsville
Edwardsville, IL 62026

Sebert, Sarah
ISBE
100 W. Randolph, 14-300
Chicago, IL 60601

Shugart, Connie
StarNet Regions I and III
220 Prospect St.
Jacksonville, IL 62650

Sims, Barb
Illinois Service Resource Center
3 Delano Ln.
Springfield, IL 62703

Sisney, Nicole
Easter Seals Children's Development
Center
650 N. Main St.
Rockford, IL 61103

Slaght, Roseann
StarNet
5178 Hutchison
South Beloit, IL 61088

Smith, Mary
925 Mechanic
Winchester, IL 62694

Spejcher, Nancy
Project CHOICES
6S331 Cornwall Rd.
Naperville, IL 60540

Stanton, Catherine
Horace Mann School
2975 West Broadway
Blue Island, IL 60406

Stauch, Pat Kluzik
StarNet Region II
1855 Mt. Prospect
Des Plaines, IL 60018

Steinman, Topper
3706 Meadow Lane
Champaign, IL 61822

Stewart, Cheri
Jefferson School
800 4th Avenue
Dixon, IL 61021

Taylor, Pandora
Project CHOICES
6S331 Cornwall Rd.
Naperville, IL 60540

Teske, Ingeborg
2245 North Fremont Street
Chicago, IL 60614

Tompkins, Jill
Great Lakes QIC-D
196 CRC, 51 Gerty Dr.
Champaign, IL 61820

Trieschmann, Mary
Kohl's Children Museum
165 Green Bay Rd.
Wilmette, IL 60091

Valentine, Sandy
116 Mackinac Drive
East Peoria, IL 61611

Wechsler, Nick
The Ounce of Prevention Fund
122 S. Michigan Ave., Ste. 2050
Chicago, IL 60603

Weisheit, Carol
Illinois CASA
615 Normal Ave.
Normal, IL 61761

Winnega, Marrea
A.E.R.O.
7600 S. Mason Ave.
Burbank, IL 60459

Winnett, Sharron
Hillsboro CUD #3
Early Childhood Program
279 Barry-Hope Trail
Hillsboro, IL 62049

Yates, Tweety
University of Illinois
61 Children's Research Center, 51
Gerty Dr.
Champaign, IL 61820

***Don't miss Thursday evening's energetic
and creative presentation by . . .***



**Denis Berkson,
aka, the "Creative Crusader."**

NEED ASSISTANCE?

**Look for a Conference Committee
Member wearing a committee
ribbon or ask at the
Conference Registration Desk.**

***We hope you will find time to take advantage of a few
of the many historical and cultural opportunities
offered in Springfield. To find out more about the
interesting places to visit in Springfield, please visit
the Springfield Convention & Visitors Booth near the
Registration Area or speak to the hotel concierge near
the main entrance.***

2001 Sharing A Vision Conference Planning Committee

Conference Co-Chairs

Amy Santos
University of Illinois at Urbana-Champaign
Bernie Laumann
University of Illinois at Urbana-Champaign

Budget

Rob Corso
University of Illinois at Urbana-Champaign
Micki Ostrosky
University of Illinois at Urbana-Champaign
Susan Ferry
SDF Management Services

Conference Packets

Debbie Bruns
EDcetra Consulting
Nancy Hertzog
University of Illinois at Urbana-Champaign

Conference Store

Jill Biehl, Belleville, IL 62220
Jill Tompkins, Great Lakes QIC-D
Amanda Quesenberry, Great Lakes QIC-D

Credits/Credentialing

Char Ward
StarNet Regions I & III
Marlene Christ
StarNet Region VI
Pam Reising-Rechner
Illinois State Board of Education

Evaluation

Tweety Yates
University of Illinois at Urbana-Champaign
Susan Maude
Loras College

Exhibits

Chet Brandt
Illinois Early Childhood Intervention
Clearinghouse

Facilities and Hospitality

Becki White
Sauk Valley Community College
Gary Dozier
StarNet Region IV
Lisa Fisher
StarNet Region II
Daphne Laurent
Community Child Care Connection
Susan Ferry
SDF Management Services

Faculty Enrichment

Sharon Doubet
StarNet Regions I & III
Lynette Chandler
Northern Illinois University
Audrey Witzman
Illinois State Board of Education
Therese Wehman
Elmhurst College
Amy Santos
University of Illinois at Urbana-Champaign
Jean Wolfe
Western Illinois University

Job Placement

Bea Nichols
Great Lakes QIC-D

Parent Functions

Kathy Ellinor
Child and Family Connections
Sharon Gage
StarNet Region IV

Pre-Conference

Kirsten Recupido
IDHS-Bureau of Early Intervention
Jan Deissler
Illinois AEYC
Tess Bennett
Great Lakes QIC-D
Dawn Thomas
Great Lakes QIC-D
Susan Ferry
SDF Management Services

Presenters

Sharon Doubet
StarNet Regions I & III
Lynette Chandler
Northern Illinois University
Chris Lehl
Illinois State Board of Education
Pam Reising-Rechner
Illinois State Board of Education
Nancy Hertzog
University of Illinois at Urbana-Champaign
Susan Ferry
SDF Management Services

Printing and Postage

Susan Ferry
SDF Management Services

Program Booklet

Micki Ostrosky
University of Illinois at Urbana-Champaign
Debbie Bruns
EDcetra Consulting
Lynette Chandler
Northern Illinois University
Beth Delaney
University of Illinois at Chicago

Publicity

Marlene Christ
StarNet Region VI
Joan Debelak
StarNet Region VI

Registration

Susan Ferry
SDF Management Services

Showcasing

Ruta Naujokas
Office of Specialized Services
Madelyn James
National Lekotek Center
Barbara Rees
StarNet Region II

TableTalks

Sarah Sebert
Illinois State Board of Education

Volunteers and Session Facilitators

Kirsten Recupido
IDHS-Bureau of Early Intervention
Kathy Hollowich
StarNet Region IV
Becki White
Sauk Valley Community College
Lisa Fisher
StarNet Region II

Committee Member-At-Large

Donna Nylander
Indian Prairie School Dist. 204



Crowne Plaza Hotel Layout

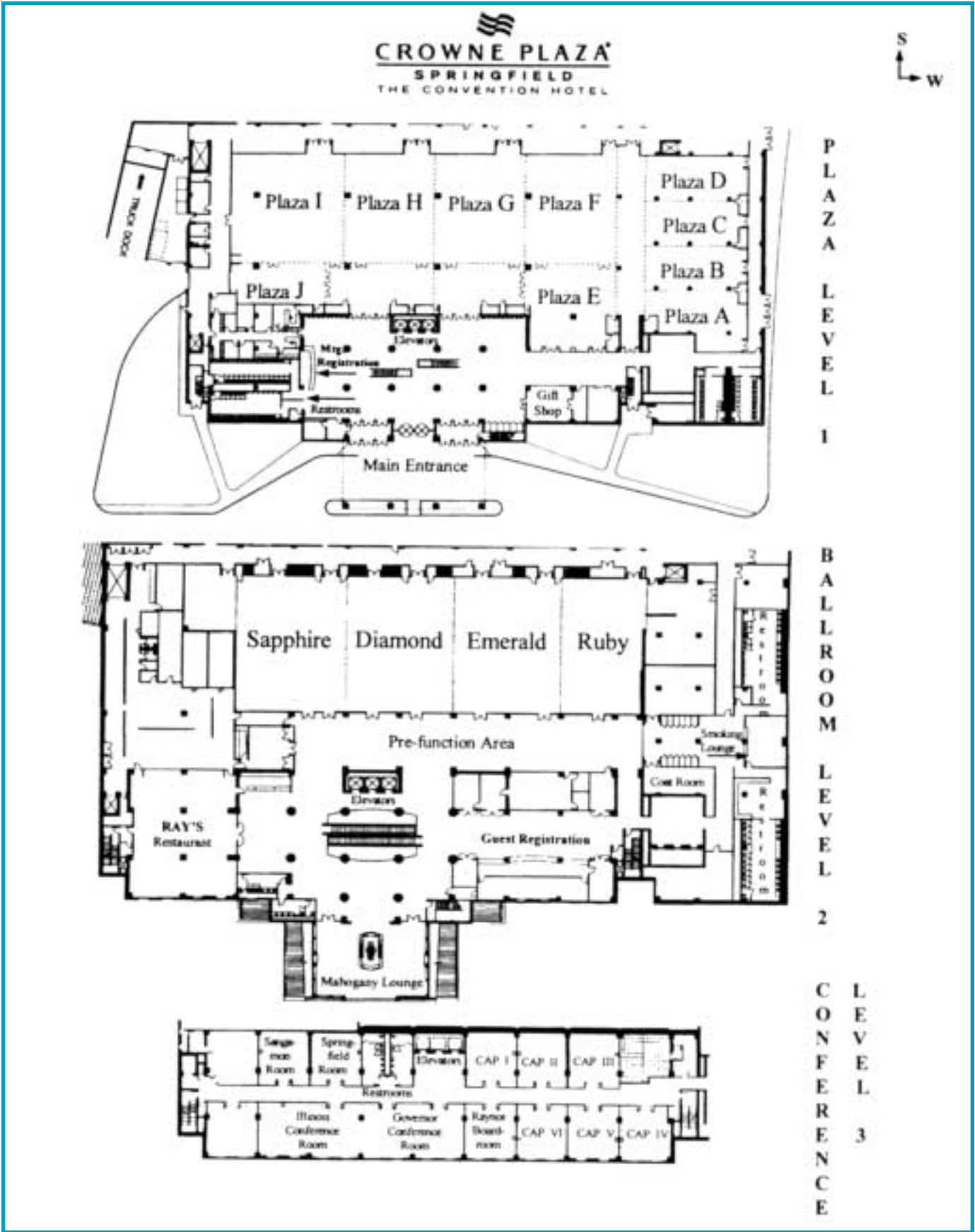

Plan to attend the
8th Illinois Early Childhood Conference
“SHARING A VISION”
September 29 – October 1, 2003

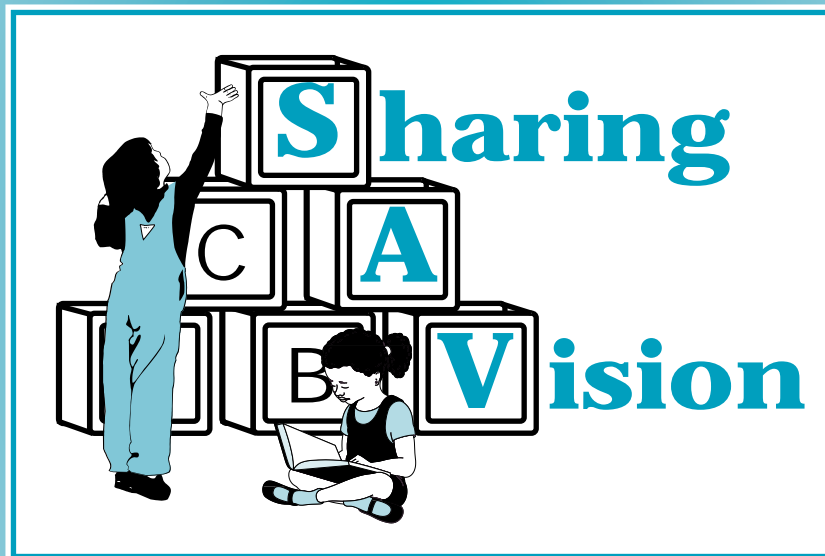

**Crowne Plaza Hotel
Springfield, Illinois**

DETAILS TO BE ANNOUNCED